

T30S R5W  
Sec 19

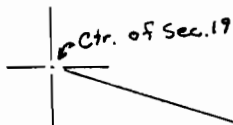

N 72° 30' 46" W  
2056.42'

COUNTY ROAD

620'S  
1760'E  
from center of  
Sec 19

Div. Pt. Located:  
1090'S & 1370'E

Well Located:  
970'S & 1660'E

both from the  
center 1/4 cor Sec 19

Scale  
1" = 100'

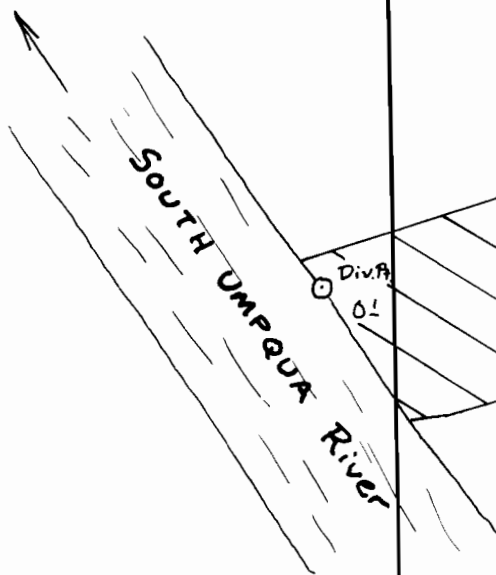

Div. Pt.  
01

WELL

G-7697  
55169

13

08  
Transfer  
3093

Roadway Easement

**FINAL PROOF SURVEY  
UNDER**

**YOCUM DLC 43**

Transfer No. 3093

Application No. 55196 Permit No. 41354  
G-7697 G-7118

IN NAME OF

**JIMMY & CARMA BURWELL**

Surveyed Feb. 8 1978 by D. Sparks

Lot 4

Lot 3

NW 1/4 SE 1/4

NE 1/4 SE 1/4