

T18S. R4W. WM.

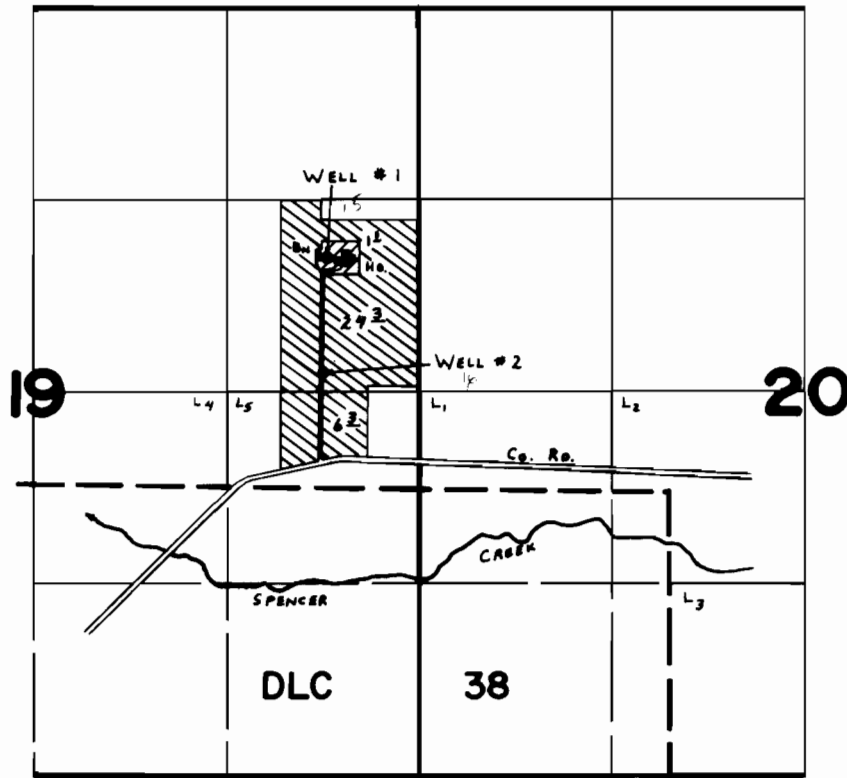

WELLS LOC: #1- 920' N. & 620' W. } BOTH FROM E. 1/4 COR. SEC. 19.
 #2- 120' N. & 650' W. }

- ▨ - IRRIGATED FROM WELL #1.
- ▩ - IRRIGATED FROM WELL #2.

FINAL PROOF SURVEY UNDER

Application No. G-5860 Permit No. G-5596
 IN NAME OF

LEW B. MYERS

Surveyed JUNE 15, 1978, by C. L. HUGHES