

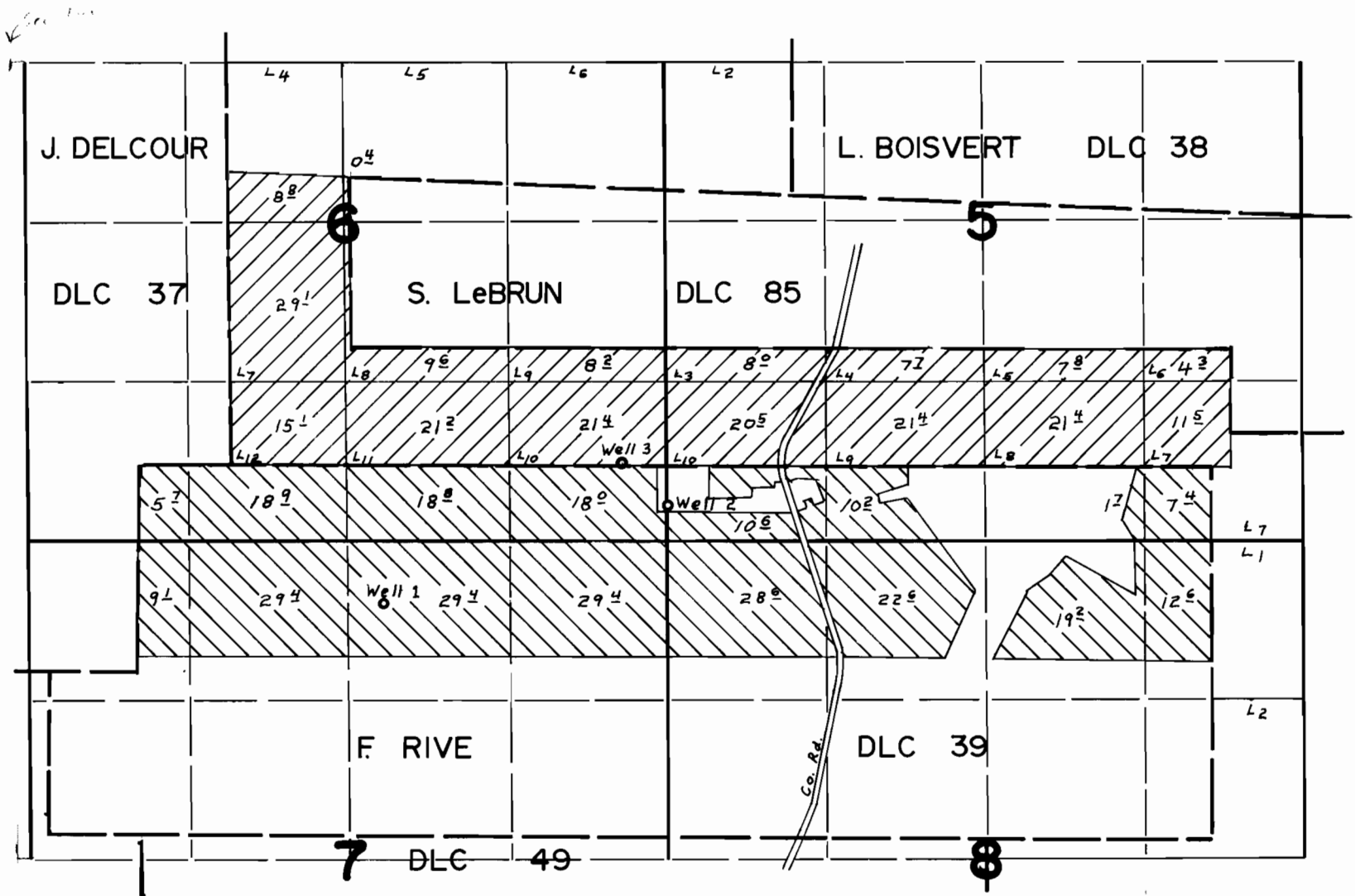

T. 5 S. R. 2 W., W.M.



Well-1 - 520'S. & 2350'W. ; Well-2 - 290'N. & 10'E. ; Well-3 - 640'N. & 370'W
 All From N.E. Cor. Sec. 7.

 App'l. G-5778 1 & 2
 App'l. G-6988

FINAL PROOF SURVEY UNDER

Application No. G-6988 Permit No. G-6494
 IN NAME OF

PHILIP E. WOLF

Surveyed SEP. 8 19 77, by B.R. SUND
 G-6988 SUR. SEP. 26, 1978, by S.P. APPLGATE