

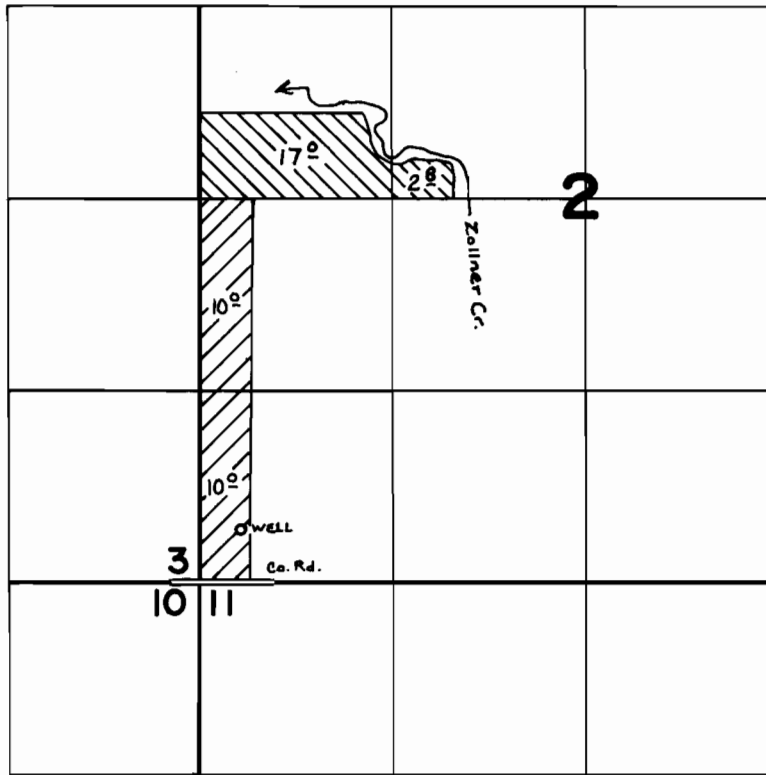

# T.6S. R.1W. W.M.



Well Located 375' N † 275' E from SW cor. Sec. 2

 Supplemental  
 Primary

## FINAL PROOF SURVEY UNDER

Application No. G-7062 Permit No. G-6801  
IN NAME OF

ALAN KRAEMER

Surveyed Sept. 7, 1977, by D. Norby