

T. 5 S. R. 2 W. W. M.

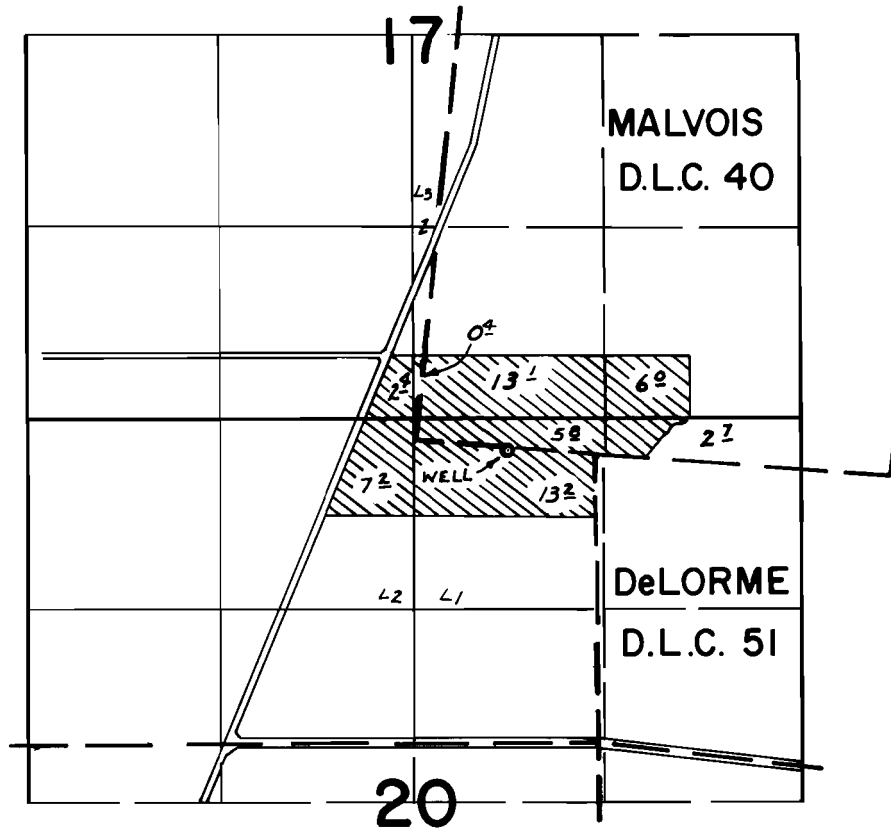

WELL LOC: 20' N. & 600' W. FROM N.W. COR. D.L.C. 51

FINAL PROOF SURVEY UNDER

Application No. *G-7169* Permit No. *G-6680*
IN NAME OF

BRENTFORD MILLER, JR.

Surveyed *AUG. 16, 1977*, by *B. R. SUND*