

# T. 4S. R. 12 & 13E. W.M.

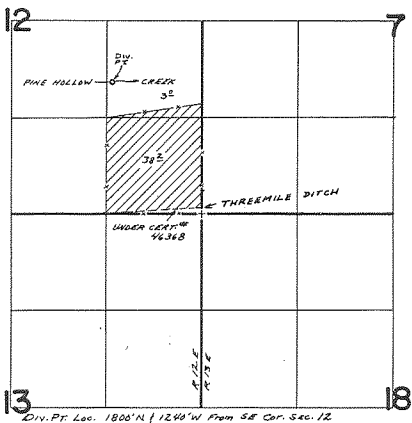

Div. Pt. Loc. 1800' N | 1240' W from SE Cor. Sec. 12

## FINAL PROOF SURVEY UNDER

Application No. 53944. Permit No. 40242.  
IN NAME OF

*William R. McAllister*

Surveyed Nov. 2, 1977, by L.H. NUNN