

T.37S.,R.6W.,W.M.

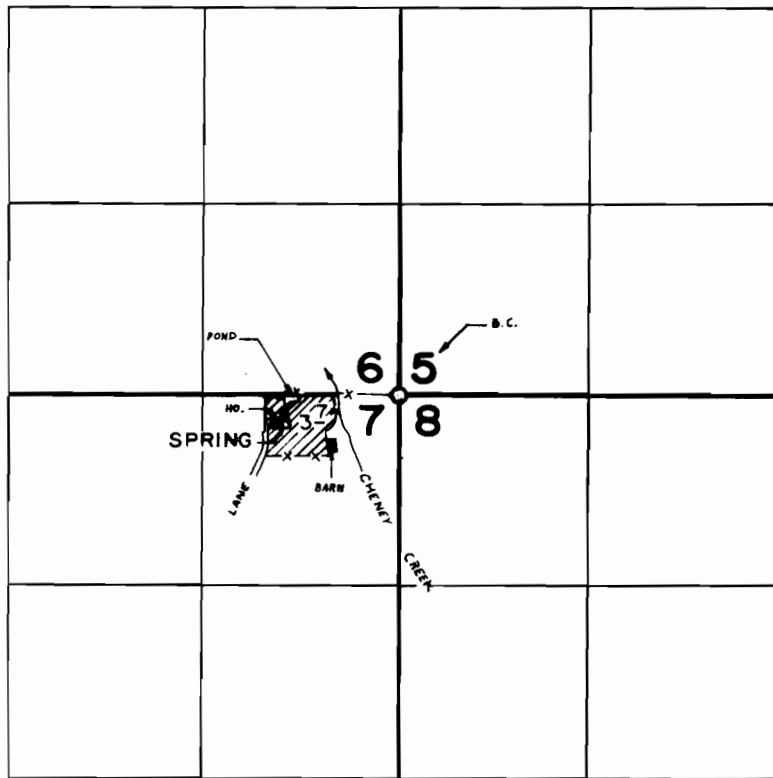

SPRING LOC.: 200' S. & 770' W. FROM N.E. COR. SEC. 7

FINAL PROOF SURVEY
UNDER

Application No. 54606... Permit No. 40975...
IN NAME OF

HAROLD & BOBBY ERDRICH

Surveyed OCT. 13... 1977., by B. SUND.....