

Sketch of Irrigation of the 6 1/2 A
of
Heinrich Jaeger RS Box 210

9253

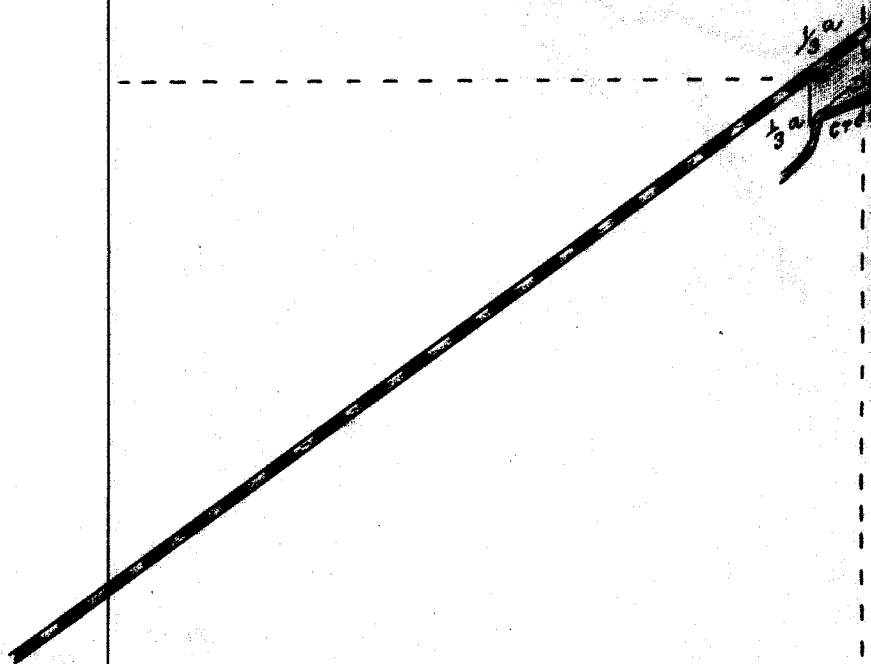

County Road Creek

1904

June 10. 19
J. J.

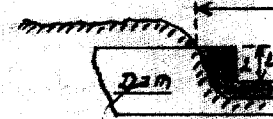

Township Seven South Range
Three West Willamette Meridian

39

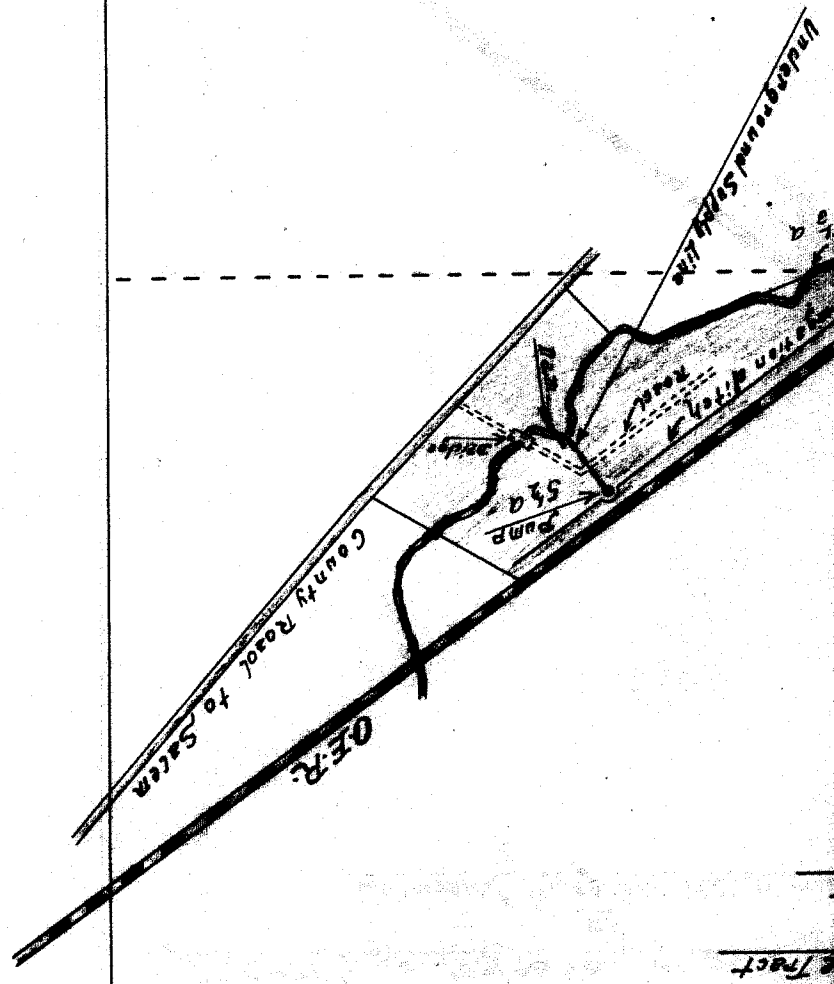

Application No. 6573
Permit No. 4146

OFFICE OF STATE ENGINEER
JUL 8 1910
ST. LOUIS - MISSOURI

