

T.14S. R.5W., W.M.

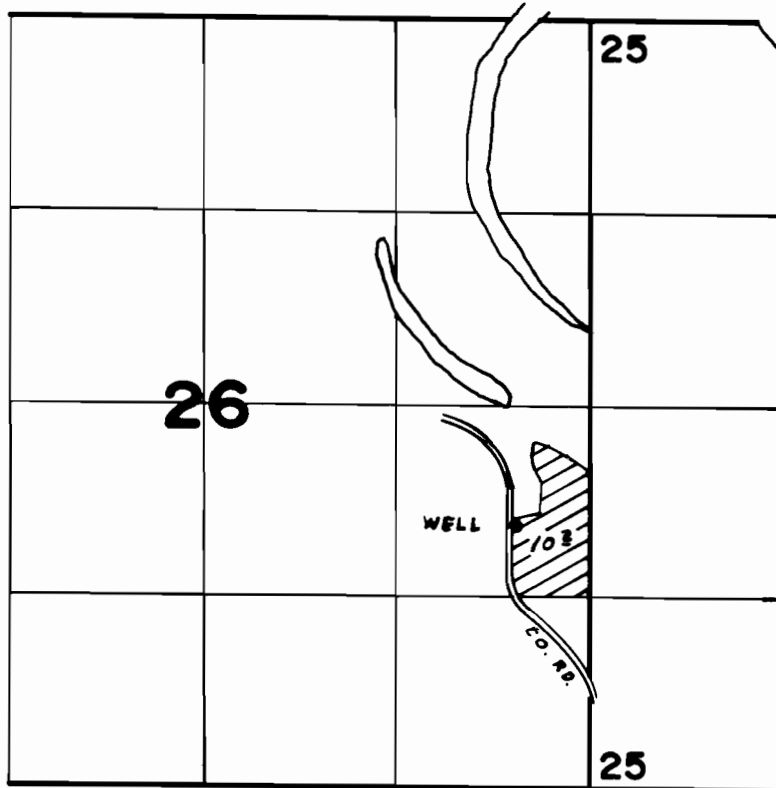

Div. Pt. Loc. 1800' N. & 500' W. From S.E. Cor. Sec. 26

FINAL PROOF SURVEY UNDER

Application No. G-5495. Permit No. G-5395.
IN NAME OF

..... A. A. WHEELER

Surveyed OCT. 4, 1978, by S. R. APPLGATE