

T. 30S. R. 5W. W.M.

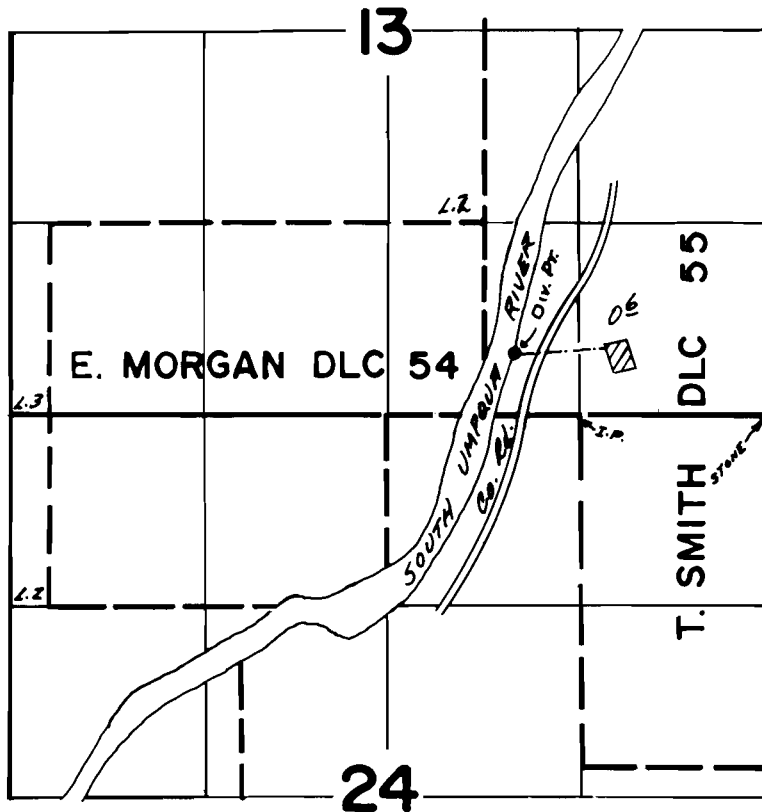

Div. Pt. Loc. - 440' N & 1748' W From SE Cor. Sec. 13

FINAL PROOF SURVEY
UNDER

Application No. 53324. Permit No. 39567.
IN NAME OF

.....**CONRAD KLOOSTER**.....

Surveyed **MAY 19 1977**, by **D.M. NORBY**.....