

T.7S.,R.4W.,W.M.

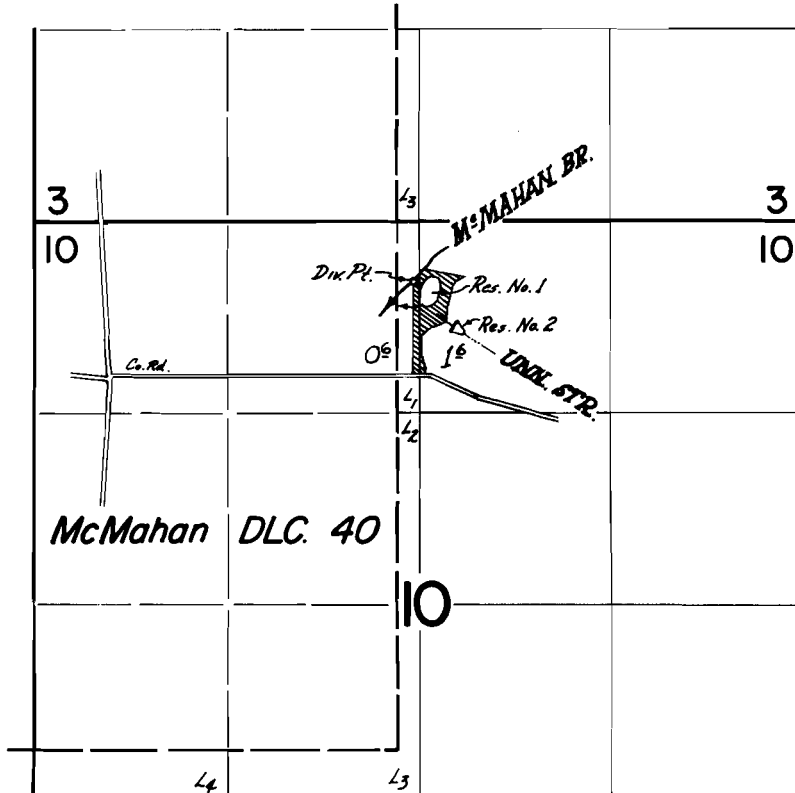

Div. Pts. located: McMahan Br. - 410' S. & 40' W.; Uncl. Str. - 730' S. & 230' E.; both from N. 1/4 cor. Sec. 10.

FINAL PROOF SURVEY

UNDER

R-52077

R-6284

52078

39241

R-52079

R-6285

Application No. 52080 Permit No. 39242

IN NAME OF

KENNETH WAYNE & JOAN ERICKSON

Surveyed Aug. 11, 1977, by L.M. Toll