

P# 6-7803  
6-7804

T.1S.,R.12E.,W.M.

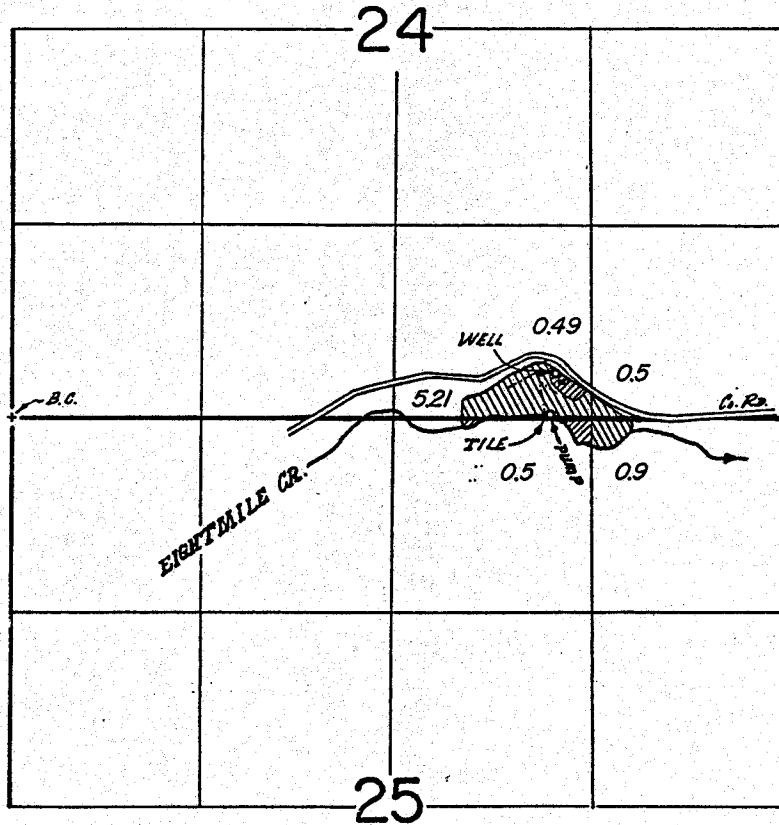

WELL LOC.; 310' N. & 3750' E.; TILE LOC.; 30' N. & 3690' E.; BOTH FROM SW COR. SECTION 24.

### FINAL PROOF SURVEY UNDER

G-8152

G-7803

▨-Prim.

▩-Suppl.

Application No. G-8153 Permit No. G-7804  
IN NAME OF

REX HAUSE

Surveyed April 26 1978, by A. M. [Signature]