

# T. 15S. R. 9W. W.M.

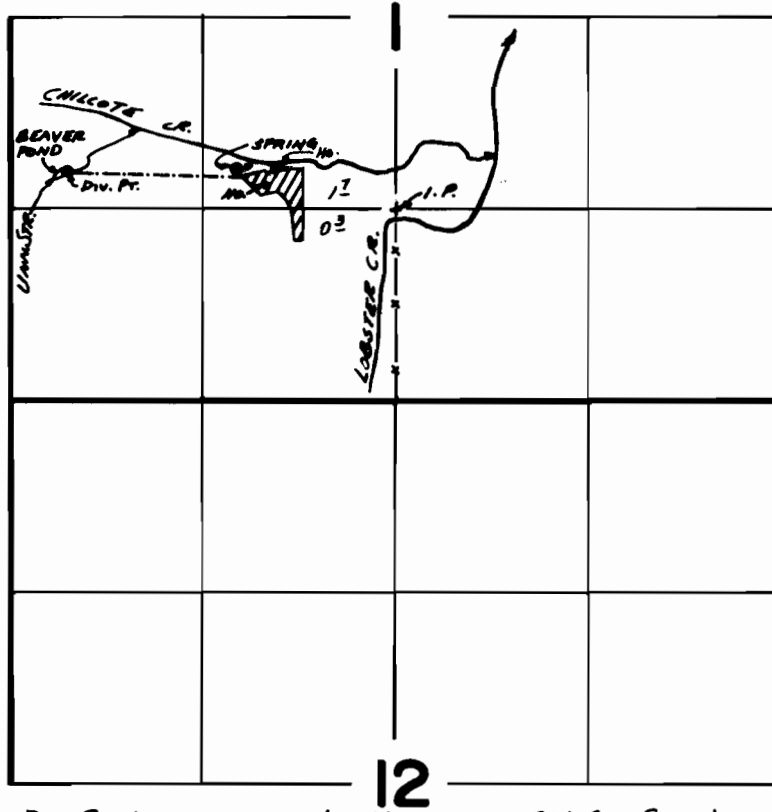

DIV. PT. LOC. 1550' N; 370' E FROM SW COR. SEC. 1  
SPRING LOC. 1570' N; 1520' E FROM SW COR. SEC. 1

## FINAL PROOF SURVEY UNDER

Application No. 55813 Permit No. 41877  
56864 42569  
IN NAME OF

WILFRED & MARGARET BUNDY

Surveyed April 10, 1978, by J.S. Donaldson