

map to accompany application for permit to appropriate the Public Waters of the State of Oregon. **Permit 38081**

Located within T2S, R9E, W.M. Hood River County, Oregon

Mt. Hood Meadows Development Corporation
Portland, Oregon

RECEIVED
FEB 9
STATE ENGINEER
SALEM, OREGON

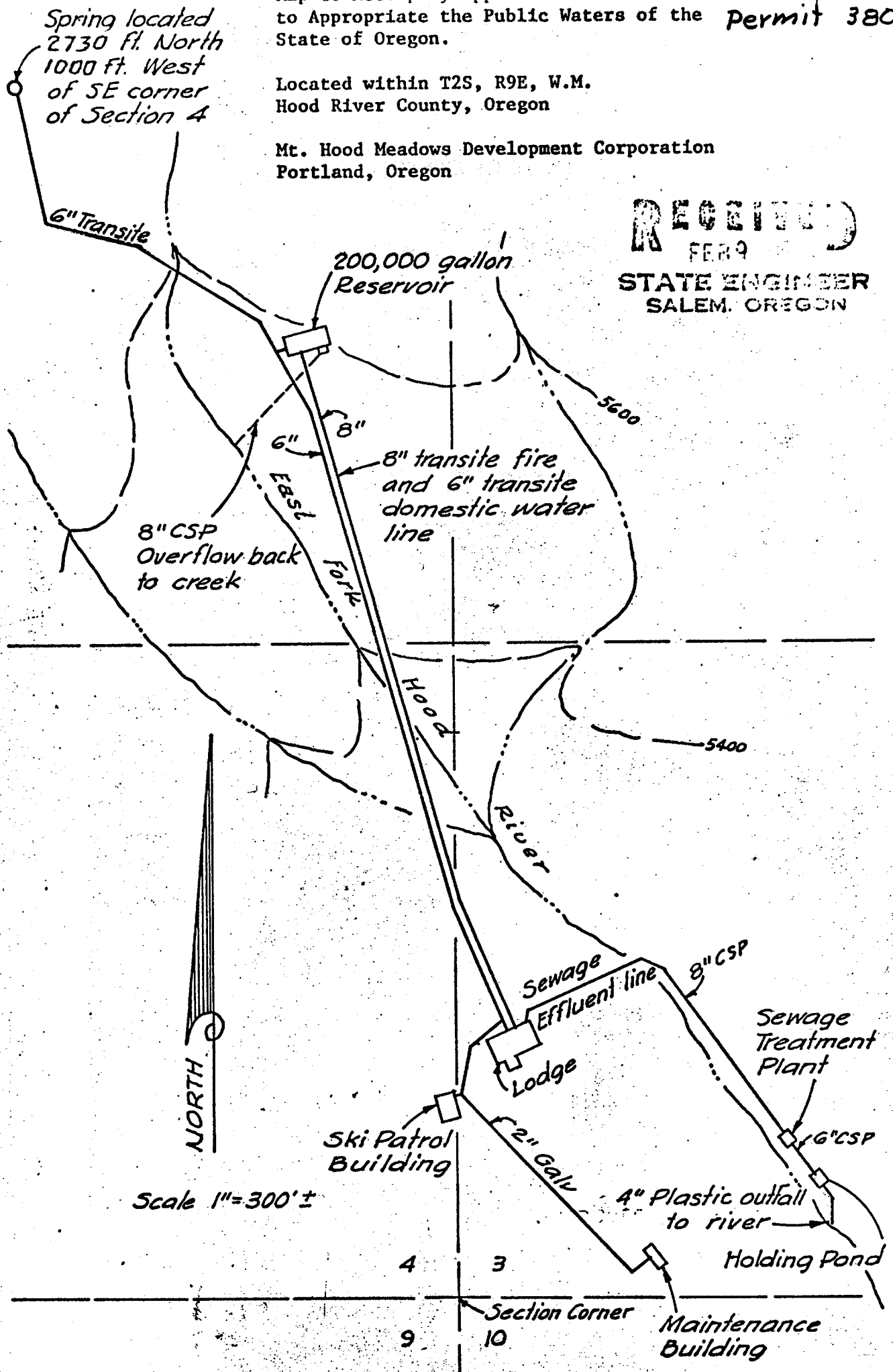

WATER SUPPLY SYSTEM
MT. HOOD MEADOWS SKI AREA