

28580  
48456

# T.34S. R.14E. W.M.

*N. Ste. Sprague Co. Map*

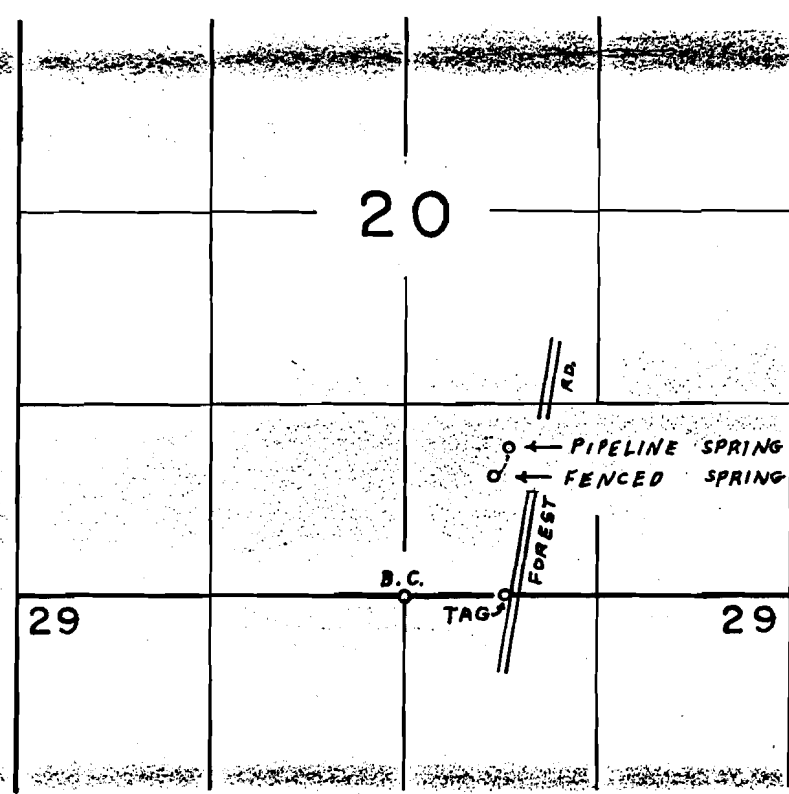

PIPELINE SPR. LOC. 1020' N. & 710' E. OF S. 1/4 COR. SEC. 20  
 FENCED SPR. LOC. 820' N. & 610' E. OF S. 1/4 COR. SEC. 20

## FINAL PROOF SURVEY UNDER

Application No. 38338..... Permit No. 28580....  
 IN NAME OF

UNITED STATES OF AMERICA

Surveyed OCT. 19... 1977., by R.G. MUCKEN...