

T9S.,R.6W.,WM.

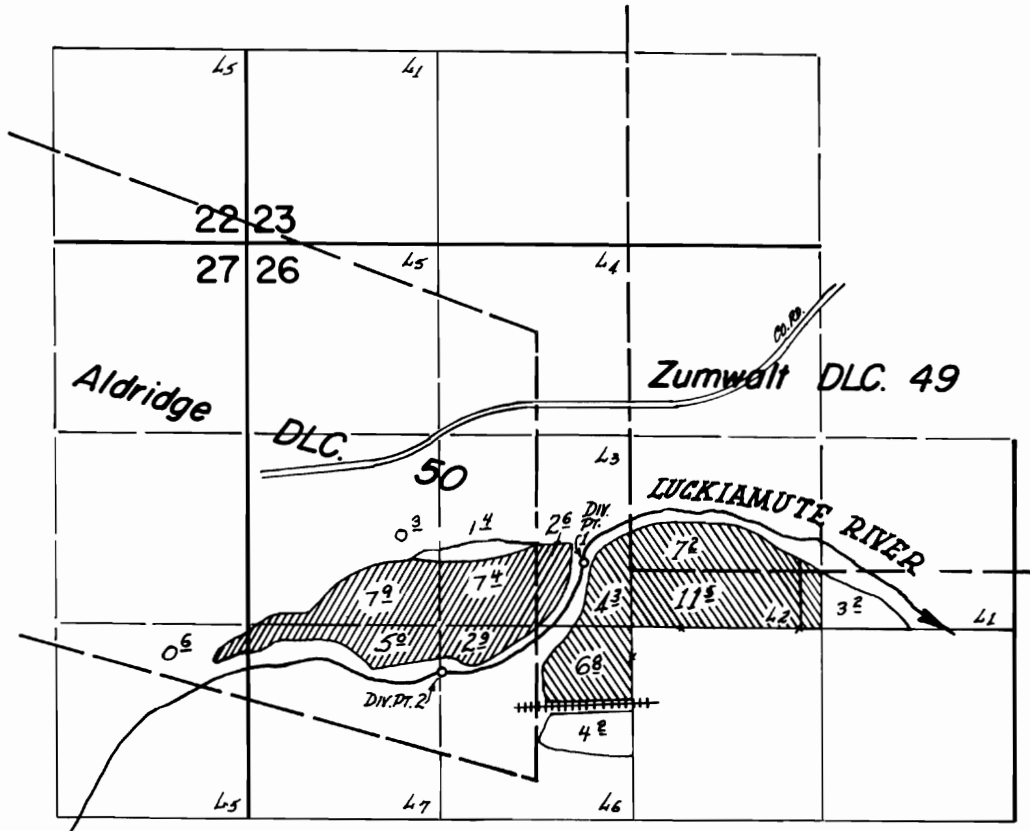

Div. Pt. 2, loc: 330'S + 1300'W. from center of Sec. 26.

Div. Pt. 1, loc: 430'N. + 320'W. from center of Sec. 26.

**FINAL PROOF SURVEY**  
UNDER

Transfer No. 2976

Application No. .... Permit No. ....  
IN NAME OF

..... MARY ISABEL WEISENSEE .....

Surveyed July 6, 1977, by L.M. TOLL .....