

NW 1/4 Sec 3 J 12 R 10 S W M.

6063

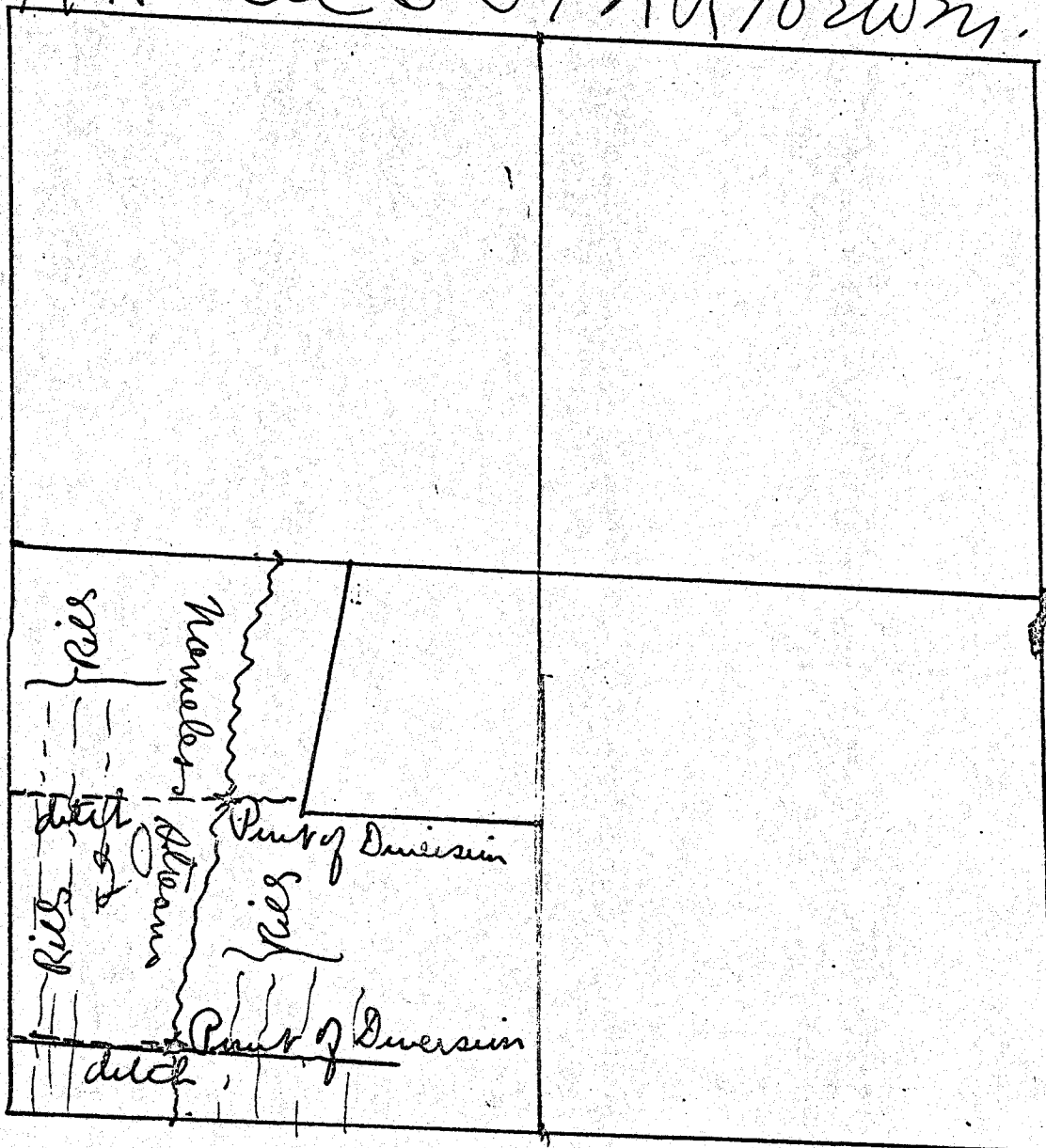

and to be marked is in the
 NW 1/4, SW 1/4 + SE 1/4 of SW 1/4 of NW 1/4
 Sec 3 J 12 R 10 S W M.

App 9218
 Per 6063

Center
 Sec 3
 J 12 R 10 S W M

STATE ENGINEER
 RECEIVED

OCT 11 1923

SALEM, OREGON

Application No. 9218