

T. 3 S., R. 3 W., W.M.

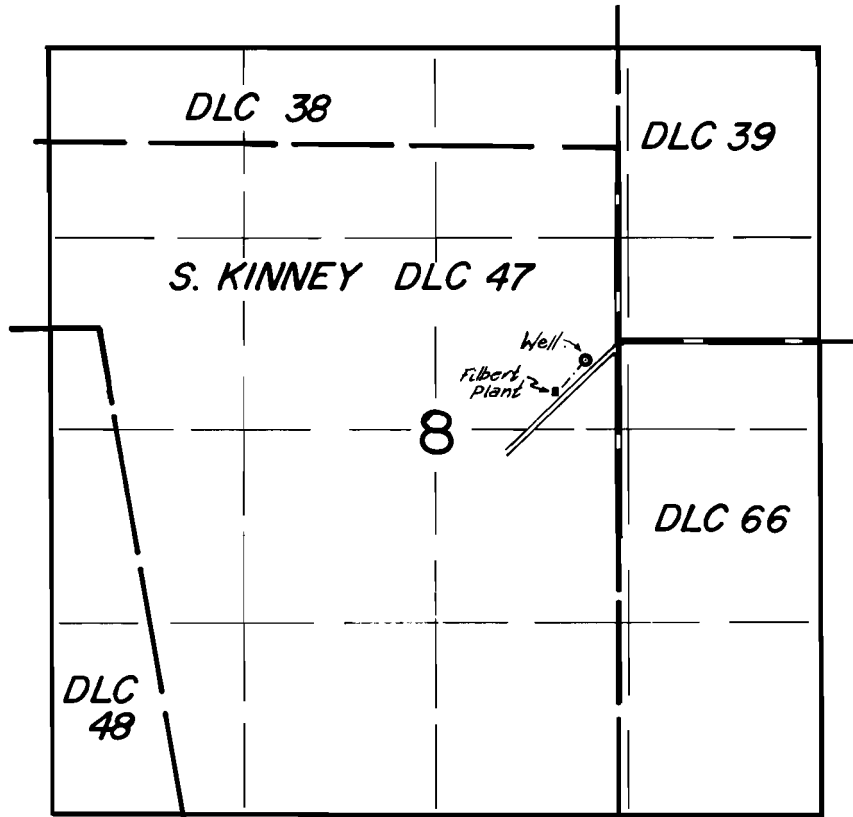

Well Loc.: 130' S. & 230' W. from NE Cor. DLC 66.

FINAL PROOF SURVEY
UNDER

Application No. G-8386 Permit No. G-7591
IN NAME OF

Fred J. Patton

Surveyed May 3, 1978, by L. H. Nunn

PT5-1978-P *JLB*