

# T.3S.R.2W.W.M.

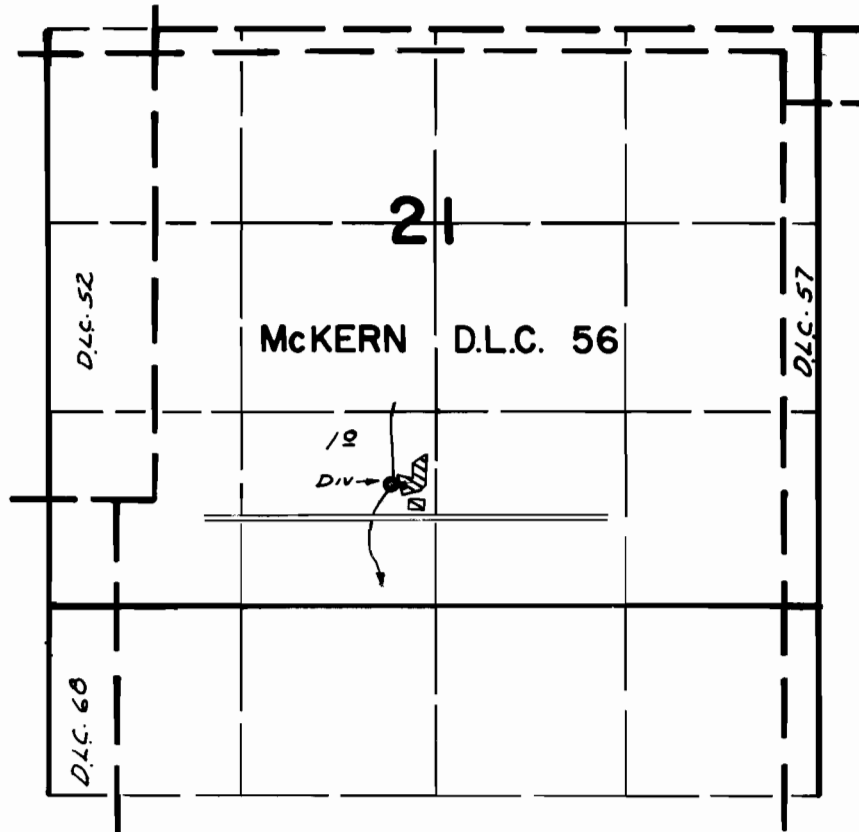

DIV. PT. LOC: 2980' S. & 1620' E. FROM N.E. COR.  
McKERN D.L.C. 56

## FINAL PROOF SURVEY UNDER

Application No. 49668 Permit No. 37189  
IN NAME OF

William O. High

Surveyed JULY 5, 1978, by R. MUCKEN