

5896
L18554

T.6N.,R.35E.,W.M.

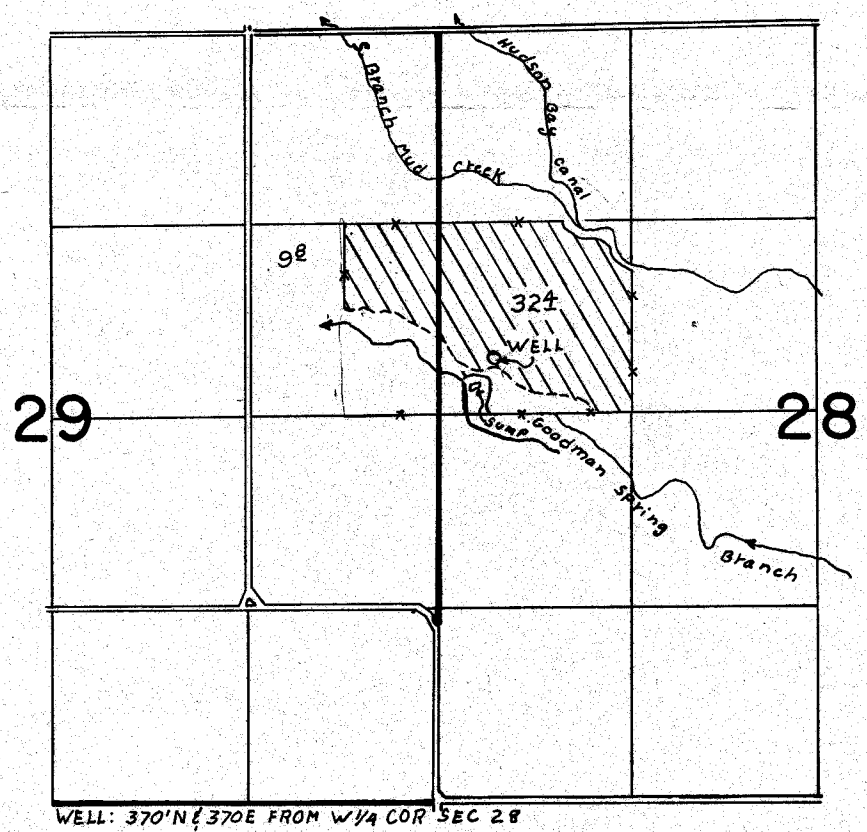

WELL: 370' N 370' E FROM W 1/4 COR SEC 28

FINAL PROOF SURVEY
UNDER

Application No. G-6254 Permit No. G-5896
IN NAME OF

PETER N. BROWN

Surveyed APRIL 9 1976, by C.R. KING