

T.2S.R.2W.W.M.

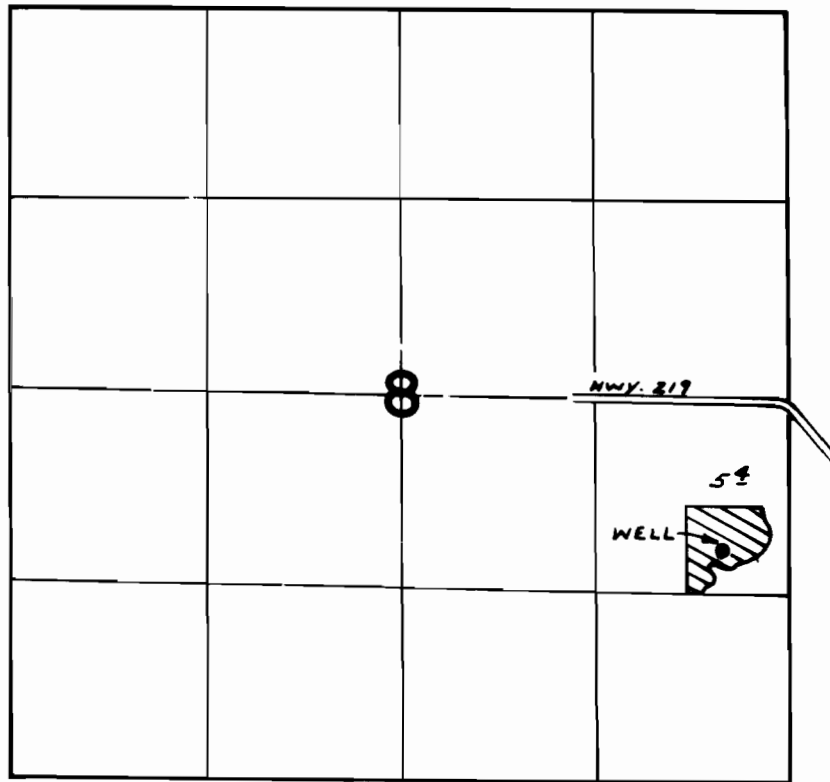

WELL LOC: 1030'S. & 450'W. FROM E $\frac{1}{2}$ COR. SEC. 8

FINAL PROOF SURVEY
UNDER

Application No. G-6185 Permit No. G-5862
IN NAME OF

VALERIE J. WOLFF

Surveyed JUNE 23 1978, by S.P. APPELEGATE