

T.15S. R.16E. W.M.

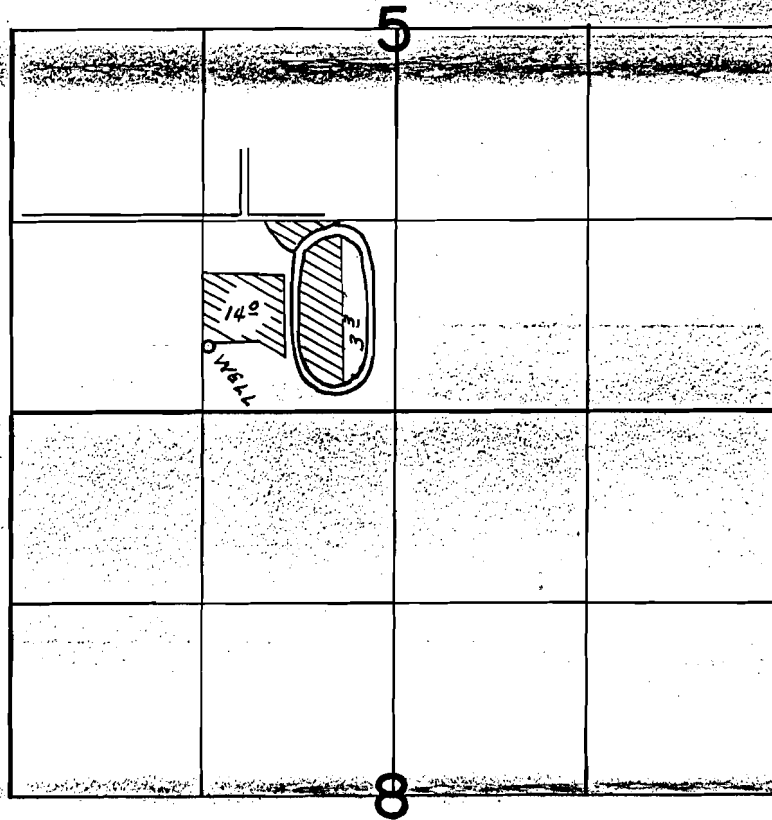

WELL LOC. 450' N & 1280' W. FROM 3/4 COR. SEC. 5

FINAL PROOF SURVEY UNDER

Application No. G-8226. Permit No. G-7741
IN NAME OF

CROOK COUNTY FAIR BOARD

Surveyed JUN. 8. 1978. by L.H. NUNN