

42426  
48595

Carl A. & Margaret Brower

in name of U.S.F.S.

P.O. Box 563

Crescent City, Calif. 95531

T 37 S R 5 E sec. 10

*Yosemite Co. 1/4 sec.*

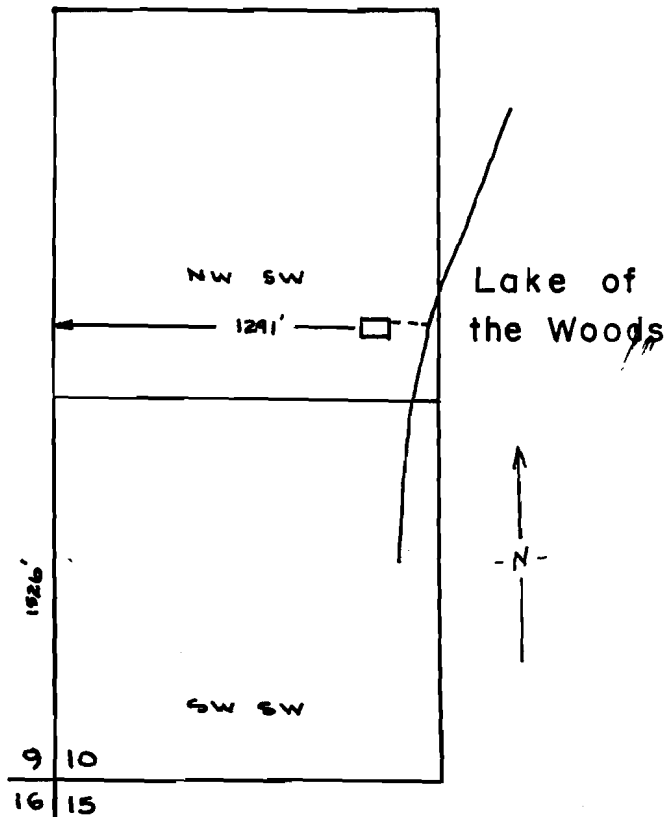

scale 8" = 1 mile

THIS MAP PREPARED BY:

*David E. Brower*

FROM INFORMATION FURNISHED BY  
THE APPLICANT.

Application No. 56620  
Permit No. 42426