

# T. 27S. R. 16E. W.M.

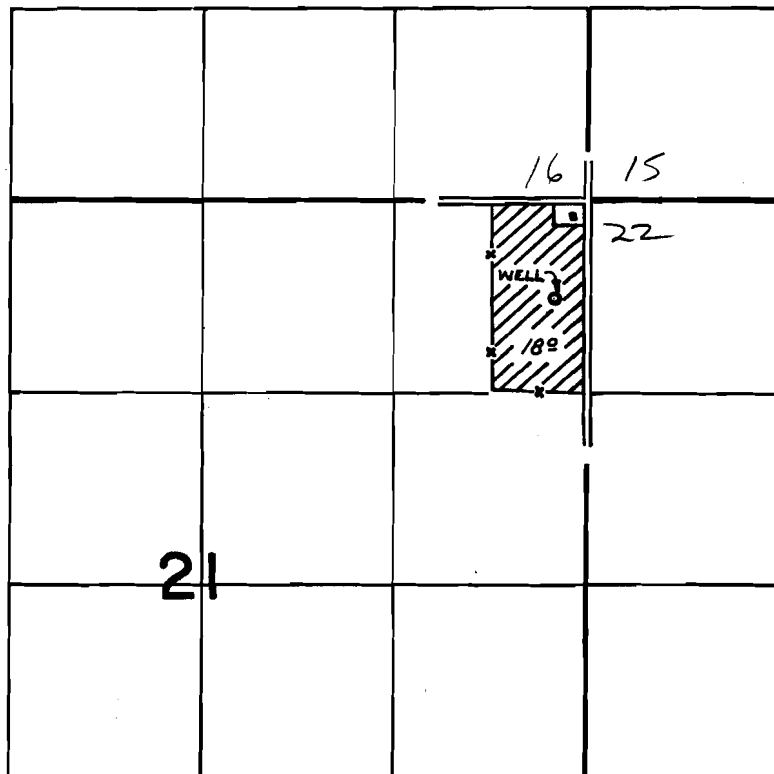

WELL LOC: 680'S & 230' W. FROM N.E. COR. SEC. 21

## FINAL PROOF SURVEY UNDER

Application No. *G-6253* Permit No. *G-5895*  
IN NAME OF

.....*KENNETH E. POWELL*.....

Surveyed *AUG. 30, 1978*, by *S.P. APPELGATE*