

42042
48626

T.37S. R.5E., W.M.

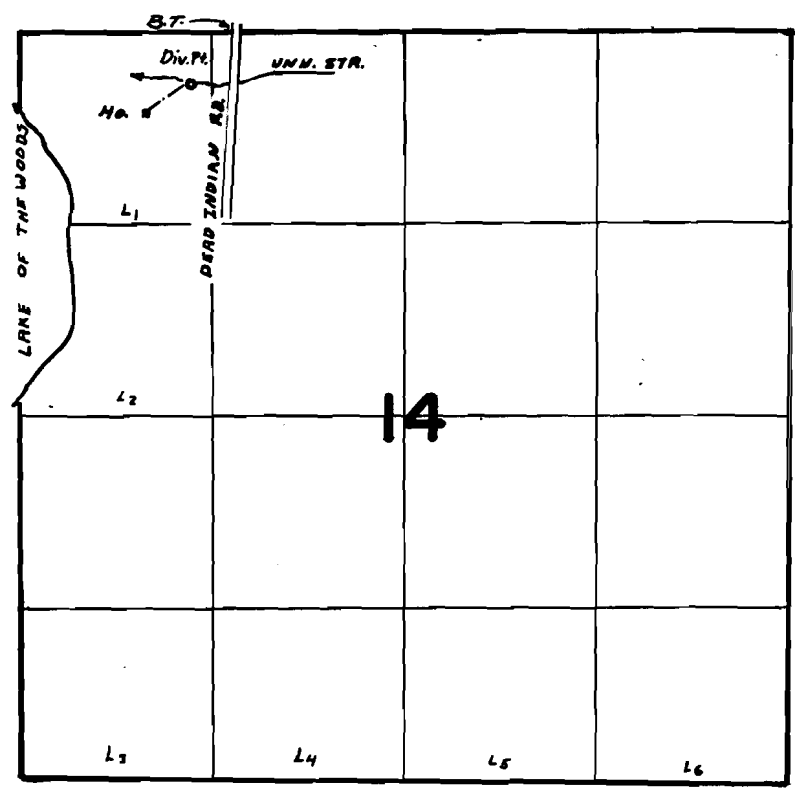

Laminar case ! mod.

DIV. Pt. Loc. 350' S. & 1170' E. From N.W. Cor. Sec. 14

FINAL PROOF SURVEY UNDER

Application No. 56537..... Permit No. 42042.....
IN NAME OF

.....JOHN T. ROGNAAS.....

Surveyed JUL. 29. 1978., by S.P. APPELEGATE