

# T.3S. R.45E., W.M.

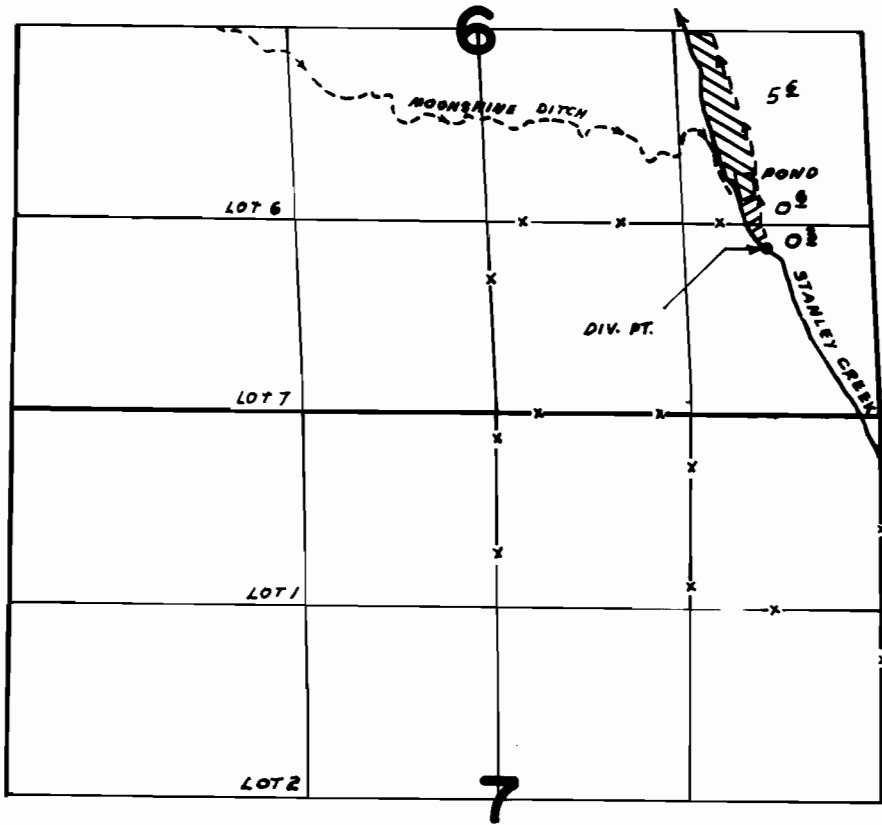

DIV. PT. : LOC. 1180' N. & 720' W. FROM S.E. COR. SEC. 6



PRIMARY



SUPPLEMENTAL

## FINAL PROOF SURVEY UNDER

Application No. 45903 Permit No. 34977  
IN NAME OF

.....DONALD F. BUHLER.....

Surveyed AUG. 17, 1978, by R. BARWIN.....