

T. IS. R. 4E. W.M.

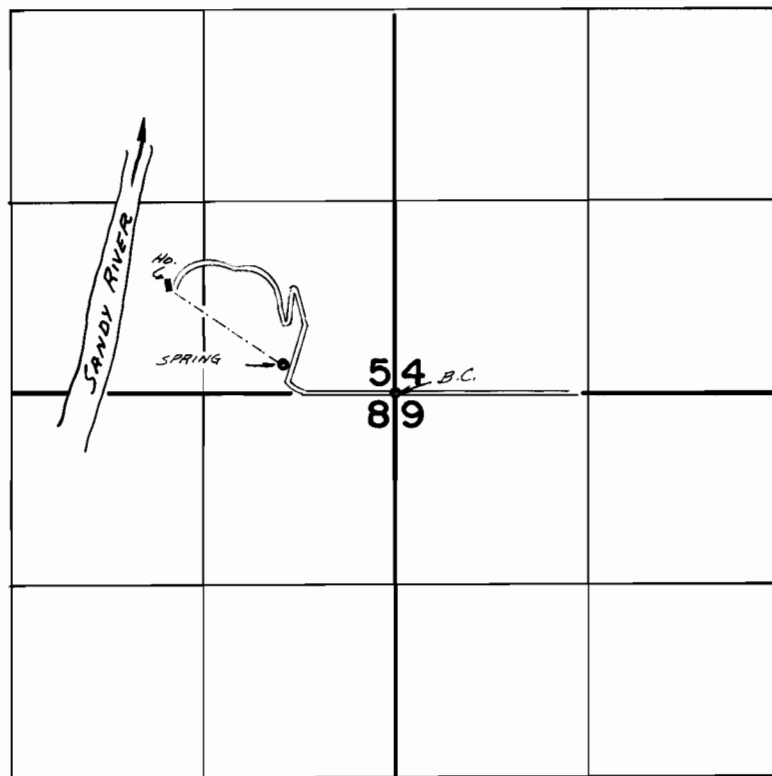

SPRING LOC. - 200' N & 760' W FROM SE COR. SEC 5

FINAL PROOF SURVEY UNDER

Application No. 50374.. Permit No. 36953..
IN NAME OF

AMERICAN HELLENIC ED. CENTER

Surveyed Oct. 26, 1978, by R.G. Mucken....