

G-7779  
48688

# T. 4N. R. 28E. W.M.

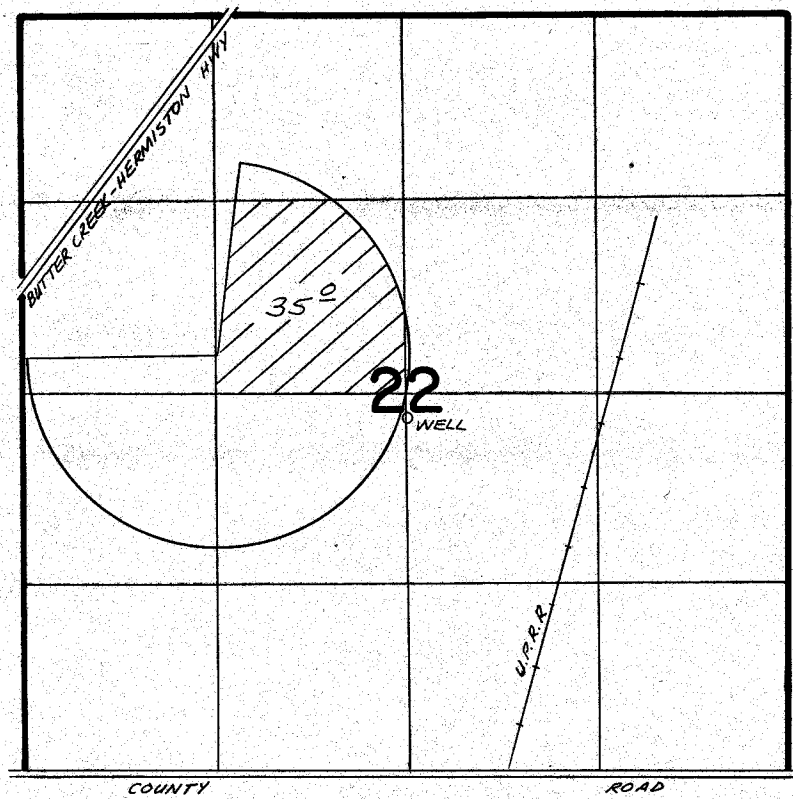

WELL LOCATED 2750' S. & 2660' E. FROM NWCOR SEC 22

## FINAL PROOF SURVEY UNDER

Application No. G.8221 Permit No. G.7779  
IN NAME OF

C & B LIVESTOCK, INC.

Surveyed MAY 1 1978, by R. BARNWIX