

T. 13S. R. 6W. W.M.

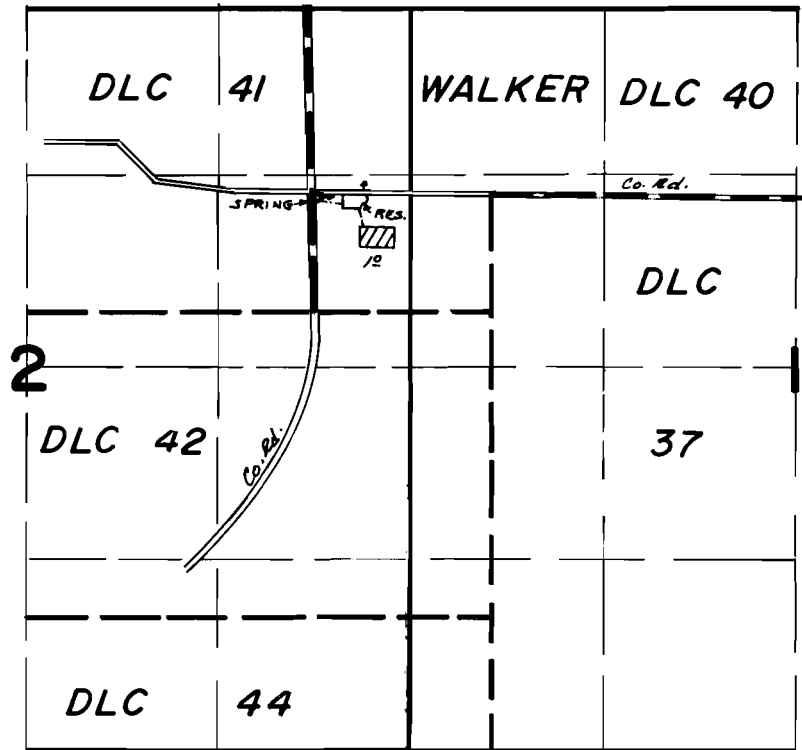

SPRING LOC. - 1320'S & 650'W FROM NE COR. SEC. 2
 RES. LOC. - 1320'S. & 320'W. FROM N.E. COR. SEC. 2

FINAL PROOF SURVEY UNDER

R-54355 R-6494
 Application No. 54356... Permit No. 40690...
 IN NAME OF

.....ADELLA ALICE DAVIS.....

Surveyed March 24 1978, by J.S. Donaldson...