

# T. 13S. R. 6W. W.M.

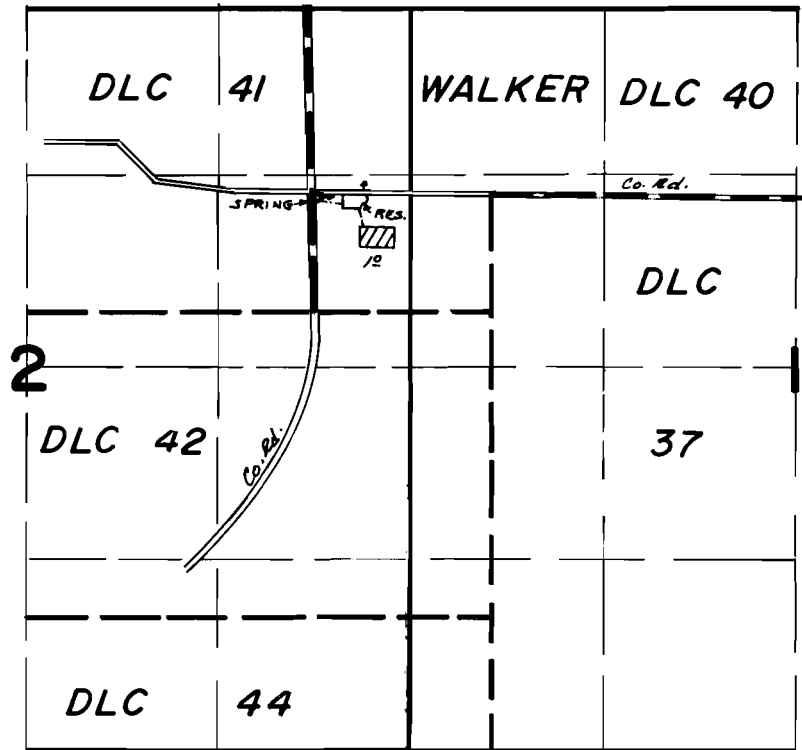

SPRING LOC. - 1320' S & 650' W FROM NE COR. SEC. 2  
 RES. LOC. - 1320' S. & 320' W. FROM N.E. COR. SEC. 2

## FINAL PROOF SURVEY UNDER

R-54355                      R-6494  
 Application No. 54356... Permit No. 40690...  
 IN NAME OF

.....ADELLA ALICE DAVIS.....

Surveyed March 24 1978, by J.S. Donaldson...