

T.30S. R.5W. W.M.

Sec. 33

SE 1/4 NW 1/4

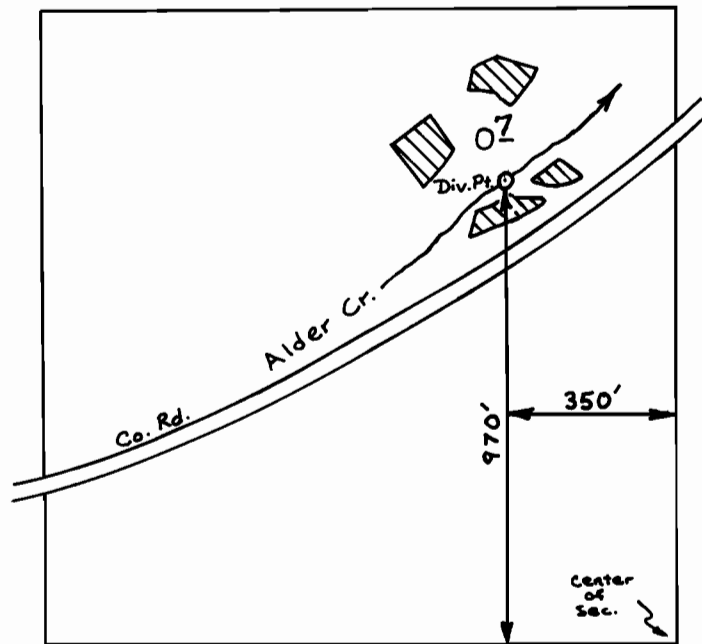

SCALE: 1" = 400'

FINAL PROOF SURVEY
UNDER

Application No. 55514 Permit No. 41842
IN NAME OF

ROBERT E. PROCTOR

Surveyed Feb. 3 1978, by D. Sparks