

RICHARD A. OADES  
Rte. 1 Box 94  
The Dalles, Oré.

368204  
**RECEIVED**  
MAR 21 1972  
STATE ENGINEER  
SALEM OREGON

S. W. 1/4 NE. 1/4 Sec. 30 T. 1 S. R. 12 E. W. M.

**RECEIVED**  
MAY 22 1972  
STATE ENGINEER  
SALEM OREGON

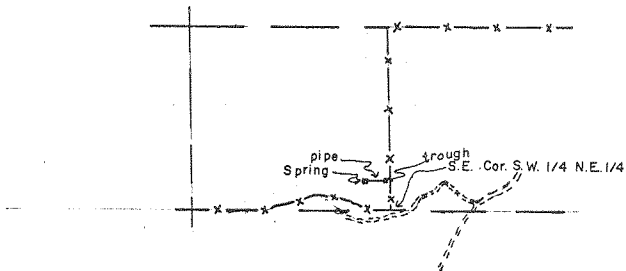

Spring located 200' North & 170' West  
of S.E. Corner of S.W. 1/4 NE. 1/4

Scale 8" = 1 mile

Application No. 49083  
Permit No. 36820