

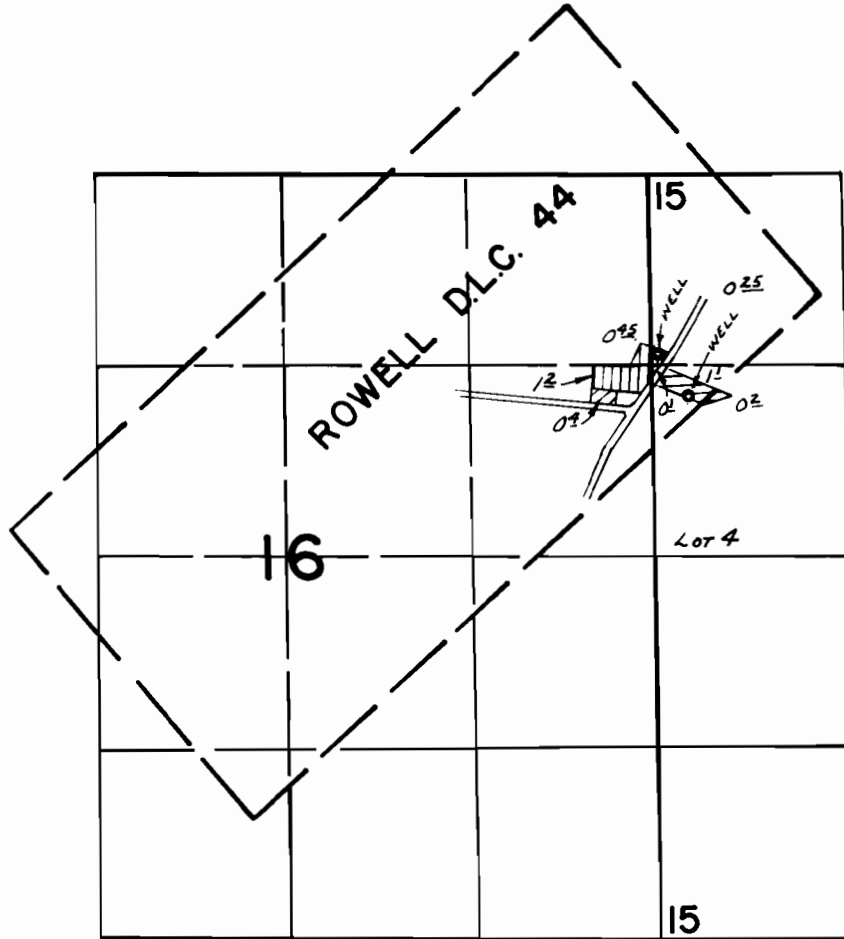

T.2S.R.2W.W.M.



WELLS LOC: 1230'S. & 50'E ; 1530'S. & 250'E, BOTH  
FROM N.W. COR. SEC. 15

**FINAL PROOF SURVEY**  
UNDER

Application No. G-7683 Permit No. G-7111 PRIM.  SUPPL.   
IN NAME OF

CHARLES A. & SYLVIA M. HAYNES

Surveyed JUNE 23, 1978, by S.P. APPLGATE