

Copy of MAP
From S-47742

T.16 & 17S., R.21 & 22E., W.M.

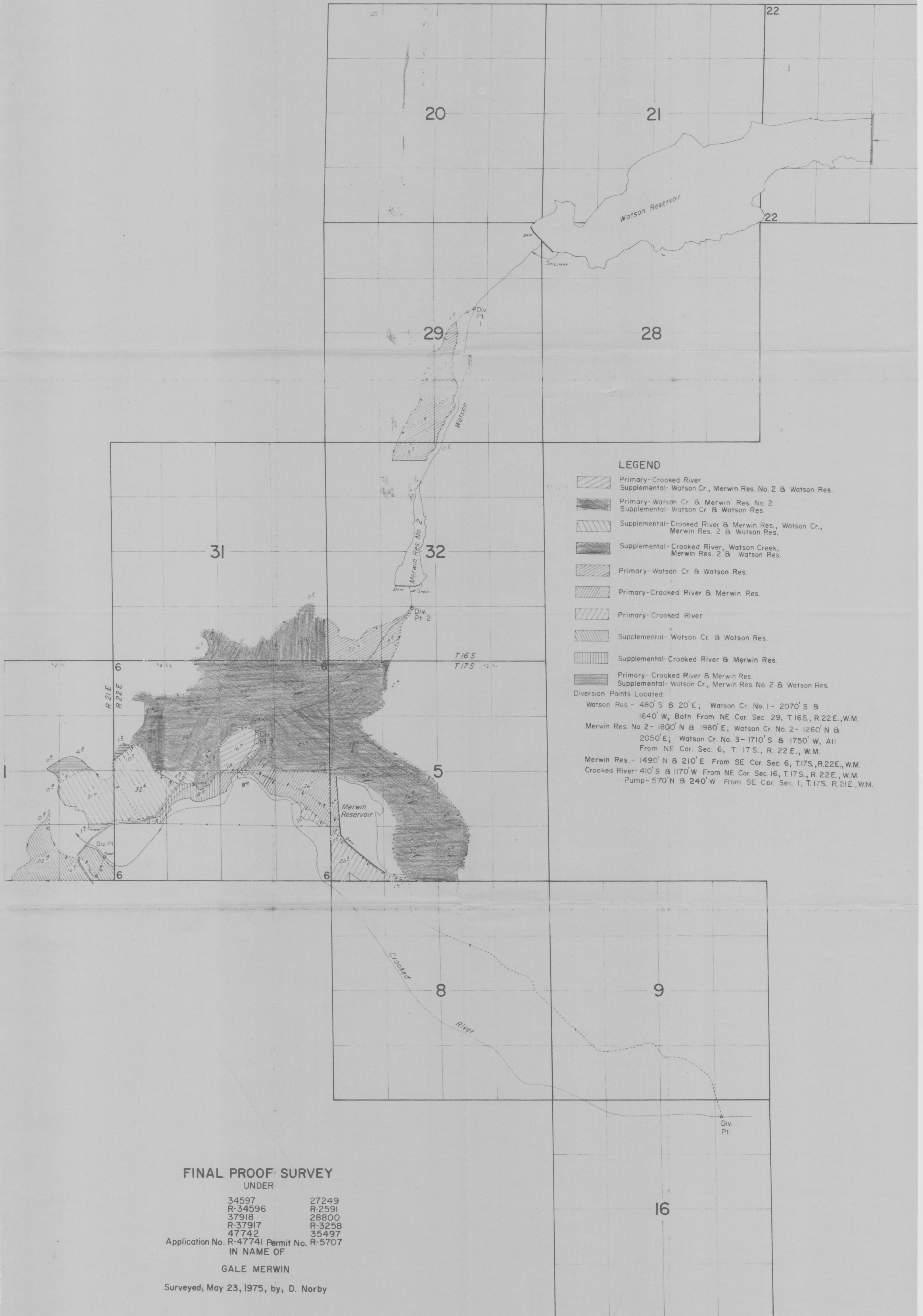

LEGEND

- Primary-Crooked River
Supplemental- Watson Cr., Merwin Res. No. 2 & Watson Res.
- Primary-Watson Cr. & Merwin Res. No. 2
Supplemental- Watson Cr. & Watson Res.
- Supplemental-Crooked River & Merwin Res., Watson Cr.,
Merwin Res. 2 & Watson Res.
- Supplemental-Crooked River, Watson Creek,
Merwin Res. 2 & Watson Res.
- Primary-Watson Cr. & Watson Res.
- Primary-Crooked River & Merwin Res.
- Primary-Crooked River
- Supplemental- Watson Cr. & Watson Res.
- Supplemental-Crooked River & Merwin Res.
- Primary-Crooked River & Merwin Res.
Supplemental- Watson Cr., Merwin Res. No. 2 & Watson Res.

Diversion Points Located:

- Watson Res. - 480' S & 20' E; Watson Cr. No. 1 - 2070' S & 1640' W, Both From NE Cor. Sec. 29, T.16S., R.22E., W.M.
- Merwin Res. No. 2 - 1800' N & 1980' E; Watson Cr. No. 2 - 1260' N & 2050' E; Watson Cr. No. 3 - 1710' S & 1750' W, All From NE Cor. Sec. 6, T. 17S., R. 22 E., W.M.
- Merwin Res. - 1490' N & 210' E From SE Cor. Sec. 6, T.17S., R.22E., W.M.
- Crooked River - 410' S & 1170' W From NE Cor. Sec. 16, T.17S., R. 22E., W.M.
- Pump - 570' N & 240' W From SE Cor. Sec. 1, T.17S. R.21E., W.M.

FINAL PROOF SURVEY
UNDER

34597	27249
R-34596	R-2591
37918	28800
R-37917	R-3258
47742	35497

Application No. R-47741 Permit No. R-5707
IN NAME OF

GALE MERWIN

Surveyed; May 23, 1975, by; D. Norby