

T.30S. R.6W. W.M.

Sec. 33

NW 1/4 NE 1/4

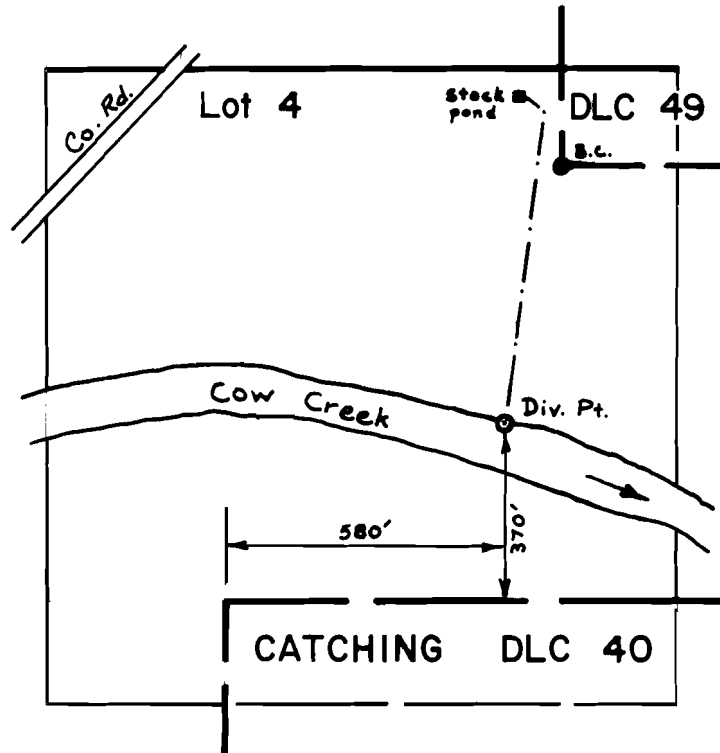

SCALE: 1" = 400'

**FINAL PROOF SURVEY**  
UNDER

Application No. 56156 Permit No. 42151  
IN NAME OF

EDMOND D. DAIGLE

Surveyed Feb. 10, 1978, by D. Sparks