

T. 29S. R. 5W. W.M.

Sec. 14

SE 1/4 NW 1/4

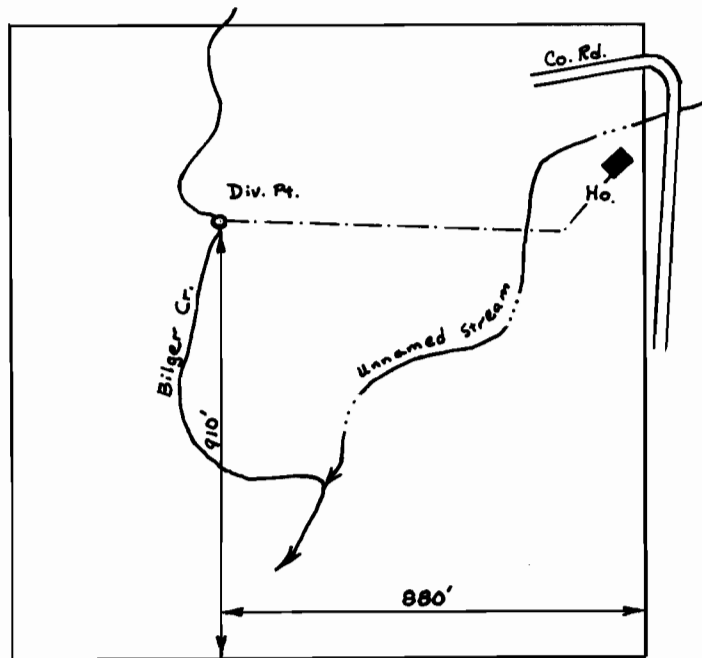

SCALE : 1" = 400'

FINAL PROOF SURVEY
UNDER

Application No. 50963 Permit No. 38471

IN NAME OF

WILLIAM K. SHIRLEY A. McCLURE

Surveyed Feb. 14 1978, by D. Sparks