

T. 25 S. R. 7 W. W.M.

Sec. 8

NW1/4 SW1/4

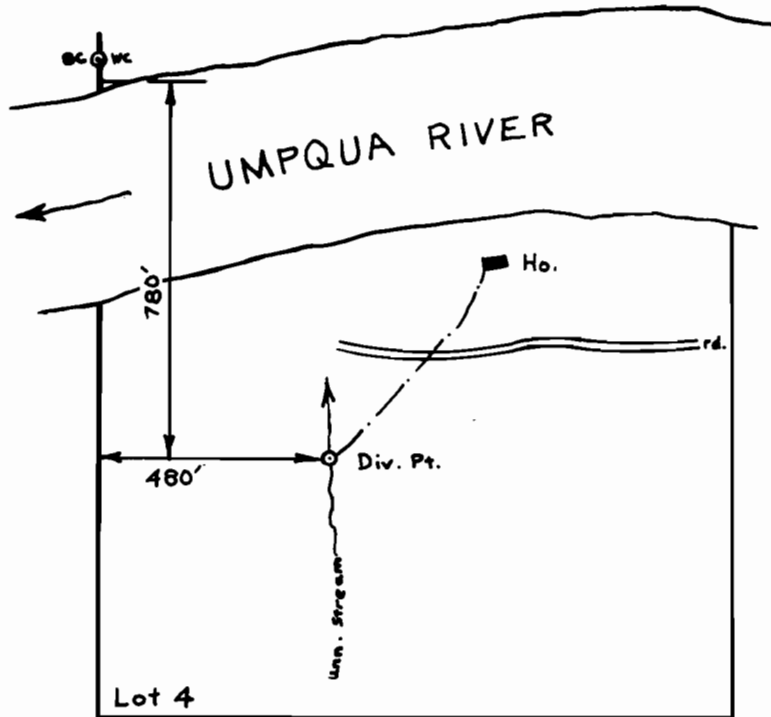

SCALE : 1" = 400'

**FINAL PROOF SURVEY**  
UNDER

Application No. 48711 Permit No. 36548  
IN NAME OF

OLIVER B. WILBER

Surveyed Oct. 30 1978, by S. Donaldson