

# T20S. R3W. WM.

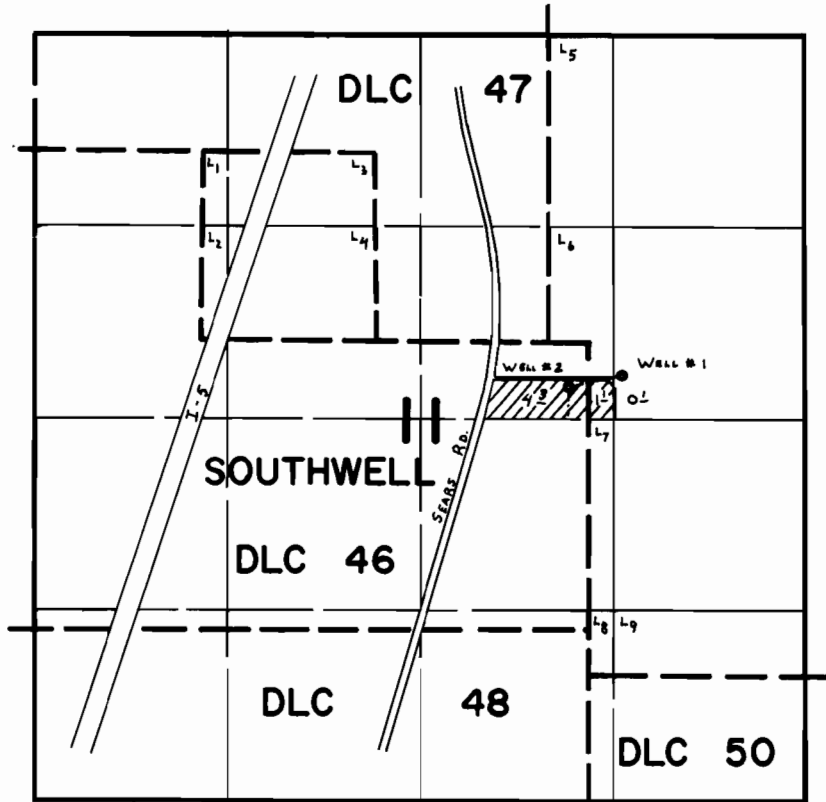

WELLS Loc: #1-300' N. { 1250' W. } BOTH FROM E. 1/4 COR. SEC. 11.  
#2-220' N. { 1610' W. }

## FINAL PROOF SURVEY UNDER

Application No. G-7218 Permit No. G-6681  
IN NAME OF

JOHN B. & J. EVANGELINE WINSLOW

Surveyed JULY 20 1978, by C. L. HUGHES