

T. 6S. R. 3W. W.M.

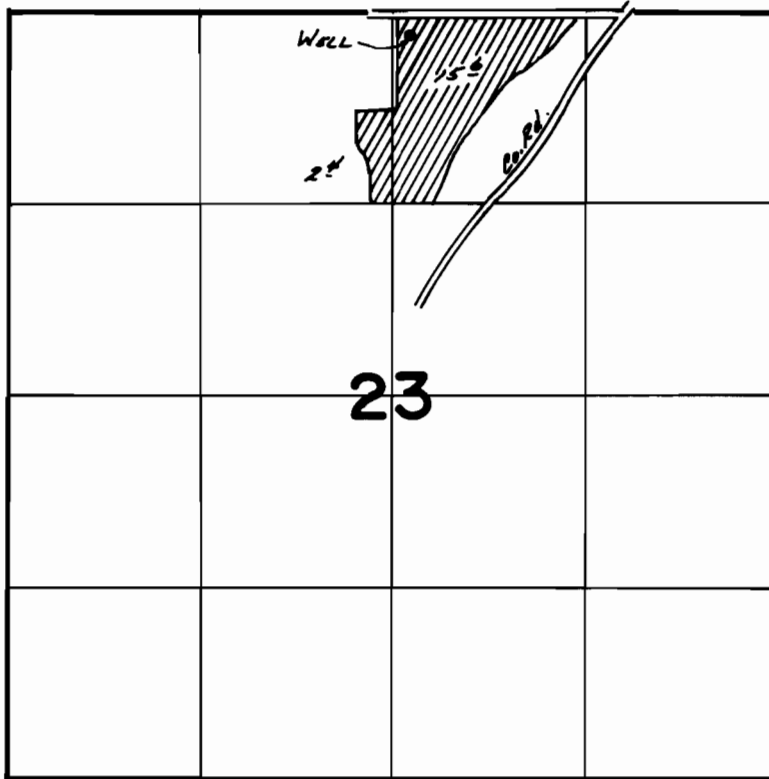

WELL LOC. - 150' S & 120' E From N¹/₄ Cor. SEC. 23

FINAL PROOF SURVEY
UNDER

Application No. G-6527 Permit No. G-6138
IN NAME OF

JOHN WIENSZ

Surveyed April 27 1978, by R.G. Mucken