

T.1N.R.48E.W.M.

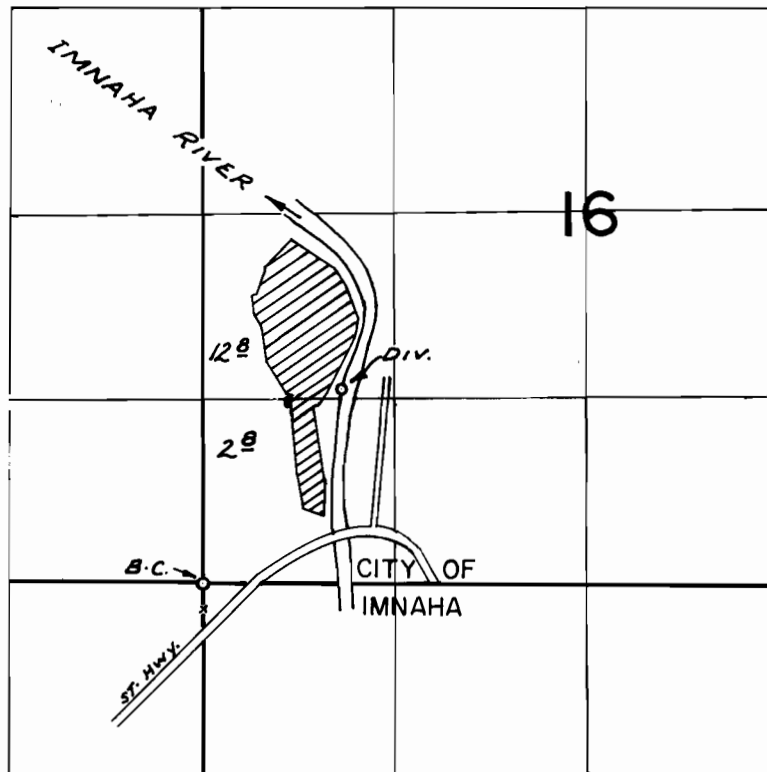

DIV. LOC: 1330'N. & 950'E. FROM S.W. COR. SEC. 16

FINAL PROOF SURVEY UNDER

Application No. 52339 Permit No. 39363
IN NAME OF

DOROTHY JUSTICE

Surveyed SEPT. 24, 1976., by R. MUCKEN.