

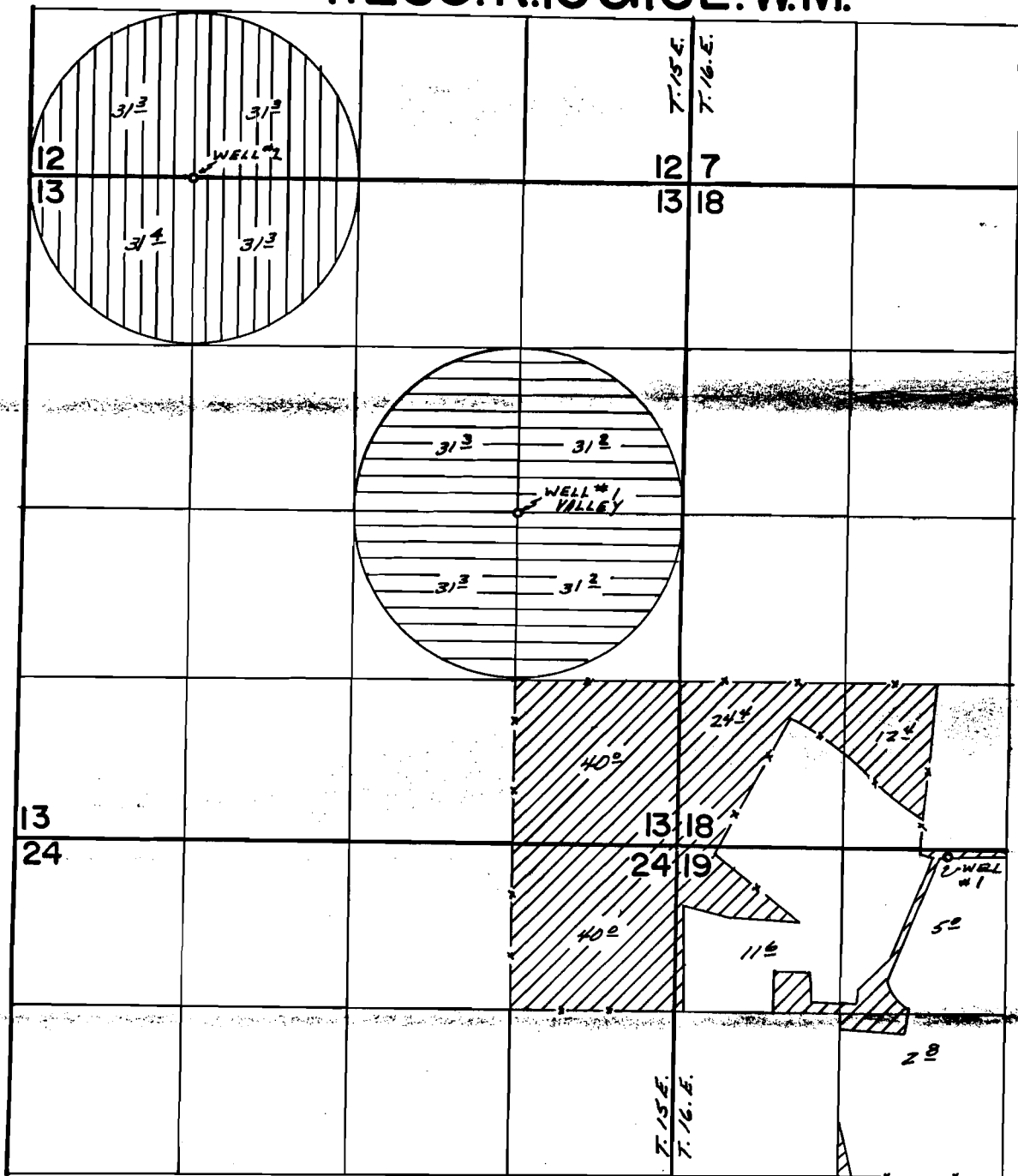



# T.28S.R.15&16E.W.M.



WELLS LOC. - #2 - 15'S & 1320'E. FROM  
NW COR. SEC. 13  
Valley #1 - 2648'N & 1320'W. FROM  
SE COR. SEC. 13  
Vaughn #1 - 50'S & 2156'E. FROM  
NW COR. SEC. 19

## FINAL PROOF SURVEY

UNDER

-  - APP. # G-7335
-  - APP. # G-7080
-  - APP. # G-6063

G-7335                      G-6772  
G-7080                      G-6552  
Application No. G-6063. Permit No. G-5755.  
IN NAME OF

VIEW POINT RANCHES

Surveyed July 15, 1977, by D.M. Norby