

T. 13S. R. 5W. W.M.

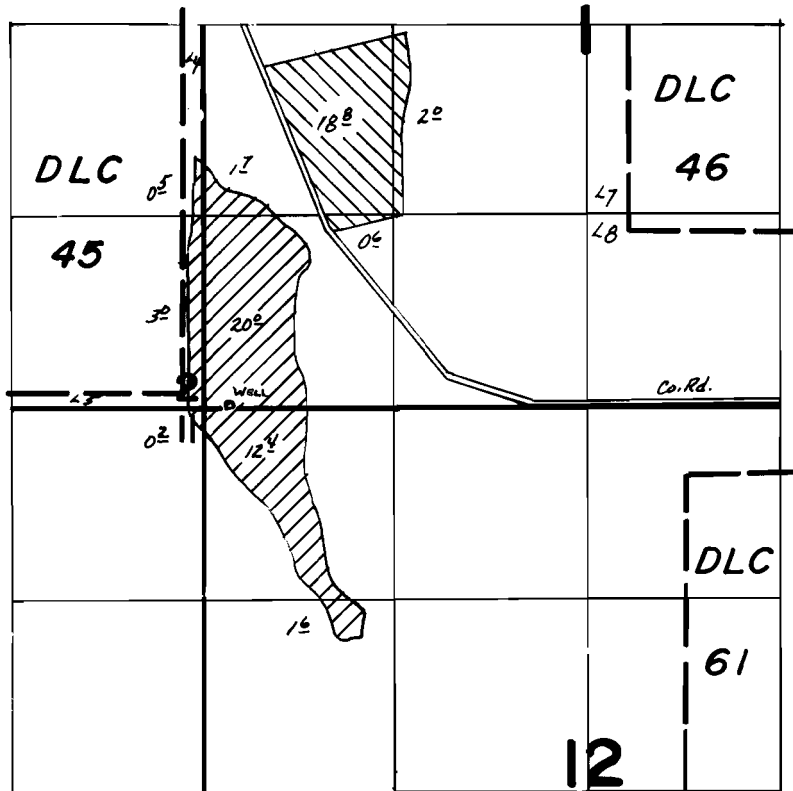

Well Loc. - 20' N & 170' E From SW Cor. Sec. 1

 - PRIMARY
 - SUPPLEMENTAL

FINAL PROOF SURVEY UNDER

Application No. G-7939 Permit No. G-7394
IN NAME OF

CARL LOVELADY

Surveyed March 23 1978, by J.S. Donaldson....