

T.28S. R.8W. W.M.

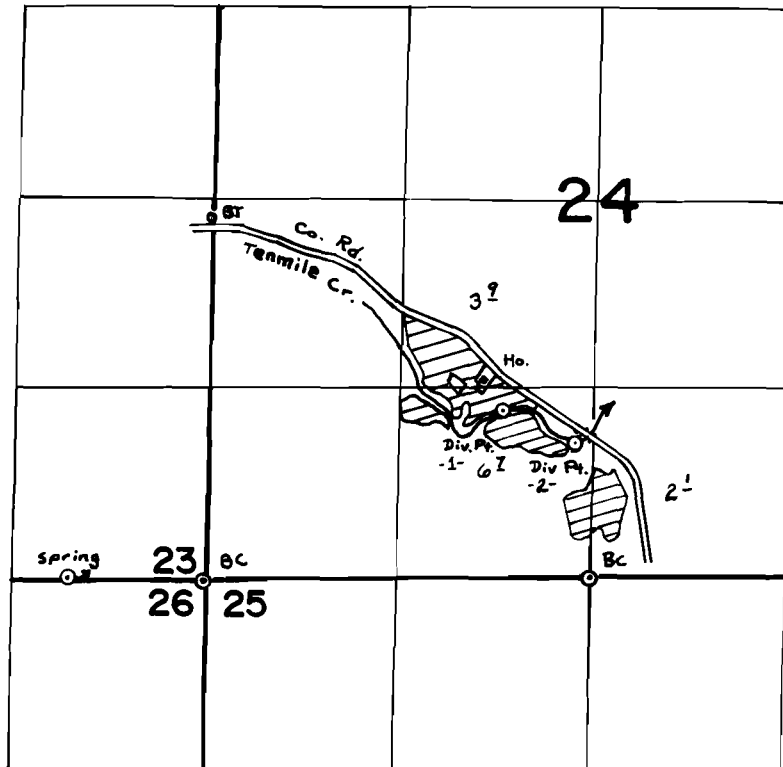

Spring Located 10' N & 940' W from SE cor. Sec. 23
Div -1- Located 1150' N & 600' W from S 1/4 cor. Sec. 24
Div -2- Located 920' N & 120' W from S 1/4 cor. Sec. 24

FINAL PROOF SURVEY
UNDER

Application No. 49636 Permit No. 36785
IN NAME OF

JOHN R. & MILDRED BECK

Surveyed Nov. 2 1978, by S. Donaldson