

T. 2S., R. 38E., W. M.

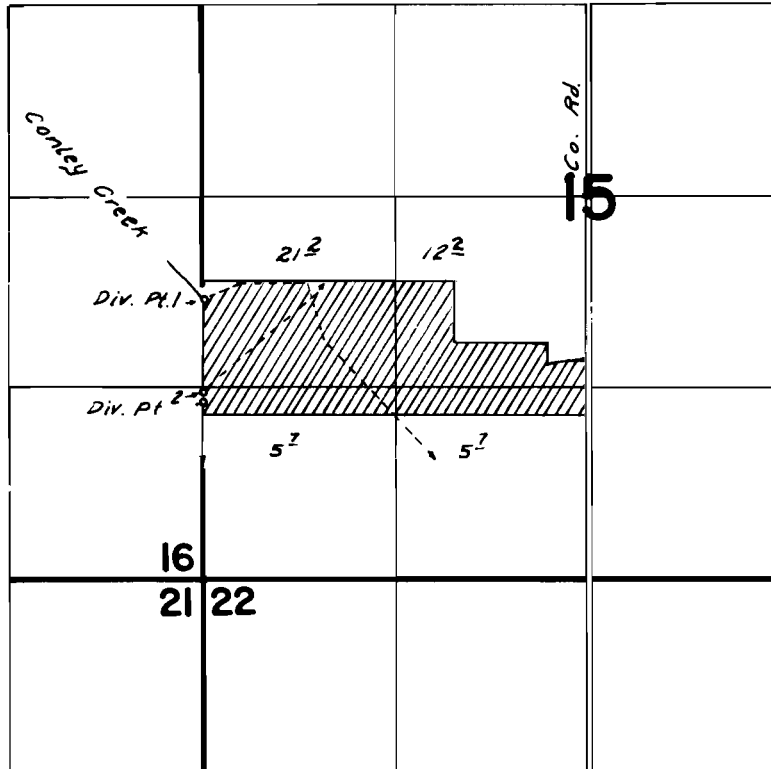

Div. Pts. Loc.: #1-700' S.; #2-1350' S.;  
both from W. 1/4 Cor. Sec. 15

**FINAL PROOF SURVEY**  
UNDER

Application No. 41451 Permit No. 30977  
IN NAME OF

Clyde L. & Elma D. Ott

Surveyed Sept. 28, 1976, by D. M. Norby  
Aug 23, 1979, by V. L. Church & D. Jarrett

PTS-1979-B  
PTS-1976-C