

T.26S., R.3W., W.M.

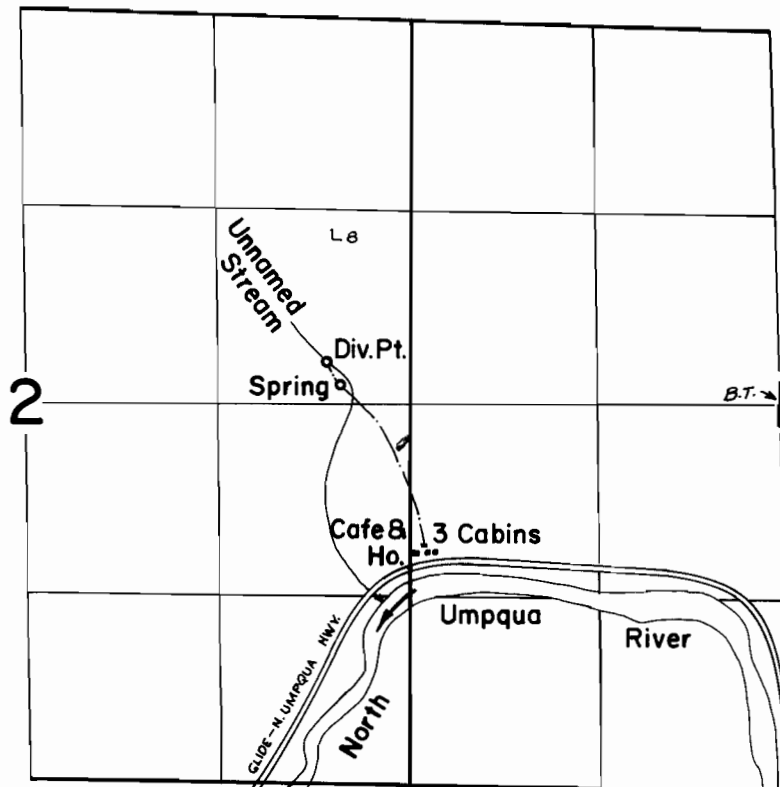

DIV. PT. LOC: 290' N & 580' W; SPR. LOC: 130' N & 480' W BOTH FROM E $\frac{1}{4}$ COR. SEC 2.

FINAL PROOF SURVEY
UNDER

Application No. 52331 Permit No. 39799
IN NAME OF
WILLIAM H. TATOM

Surveyed Aug. 31 1976, by D. Norby