

T.26S., R.2W., W.M.

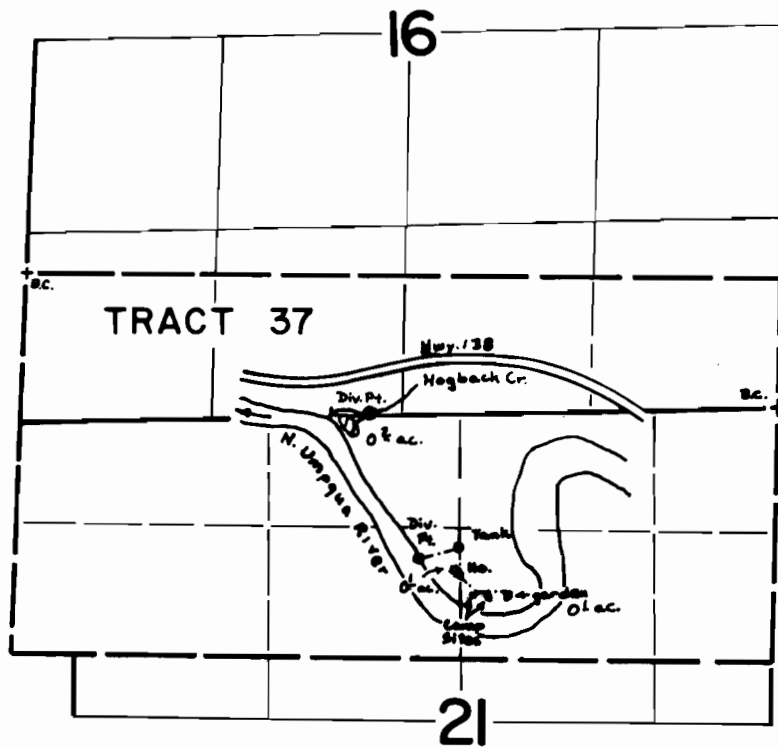

Div. Pt. Located:  
N. Umpqua River - 1870's ± 2710' E.  
from NW cor. Tract 37

**FINAL PROOF SURVEY**  
UNDER

Application No. 46622 Permit No. 34839  
IN NAME OF

JAMES H. TERRY

Surveyed Sept. 1 1976, by D. Norby  
Dec. 18 1978, by S. Donaldson