

T. 38 & 39 S., R. 1 E., W.M.

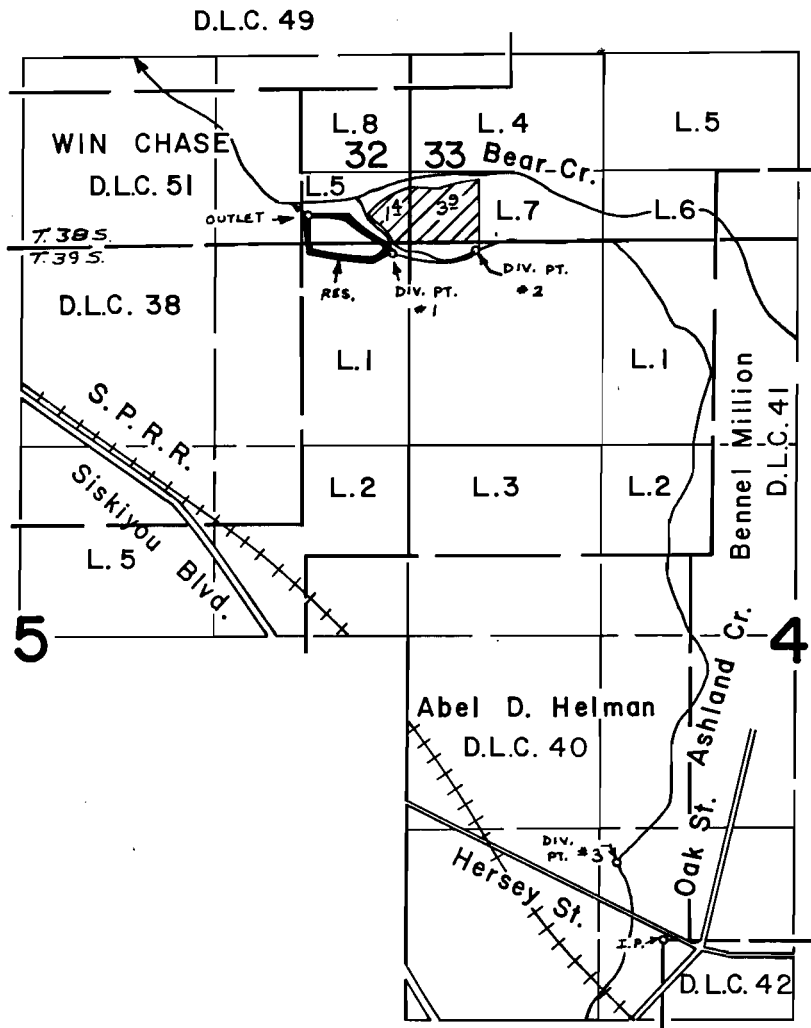

RES. OUTLET LOC. - 190' N. & 690' W.; DIV. PT. #1 - 80' S. & 120' W.; DIV. PT. #2 - 60' S. & 450' E., ALL FROM N.E. COR. OF SEC. 5. DIV. PT. #3 LOC. - 540' N. & 310' W. FROM N.W. COR. D.L.C. 42.

FINAL PROOF SURVEY UNDER

Transfer No. 2341

Application No. R-48555 Permit No. R-5833
IN NAME OF

KENNETH H. & LAURA JONES / PHILLIP F. & LUELLA BRYANT

Surveyed SEPT. 8 1978, by B. SUND

D.H.M.
P.T.S.-1978-14-C
& BAX-1AA-53