

T.7S.R.2W.W.M.

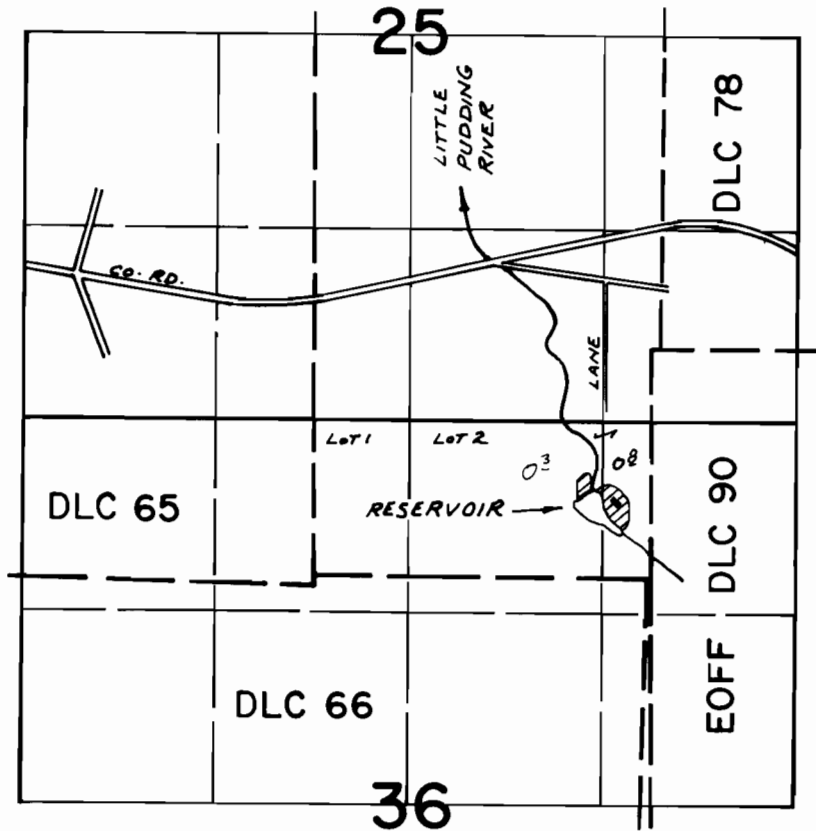

DIV. LOC: 980' S. & 400' W. FROM N.W. COR. EOFF DLC 90

FINAL PROOF SURVEY
UNDER

Application No. R-46294 Permit No. R-5507
46295 34579
IN NAME OF

MICHAEL EDWARD & SHEYRL MARIE LEE

Surveyed AUG. 5, 1976, by R. MUCKEN
MAY 16 1979 L. H. NUNN