

T2S. R1E. WM.

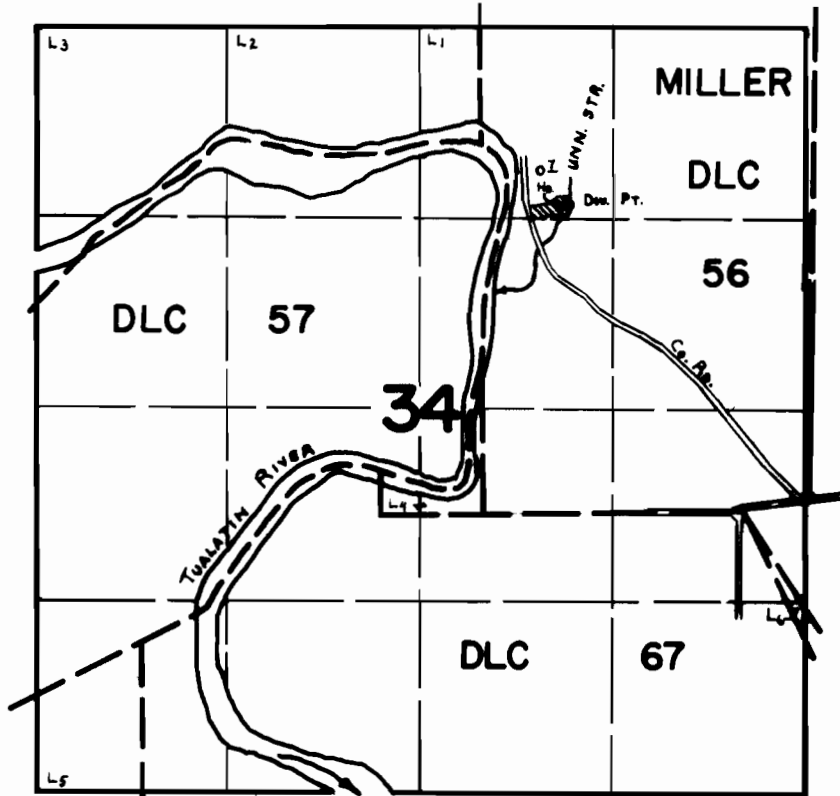

Div. Pt. Loc: 1220' S. & 1620' W. fr. N.E. Coa. Sec 34.

FINAL PROOF SURVEY UNDER

Application No. 56623... Permit No. 42629...
IN NAME OF

HENRY J. TATE

Surveyed JUNE 8, 1978, by C. L. HUGHES