

# T.36 S., R.3 W., W.M.

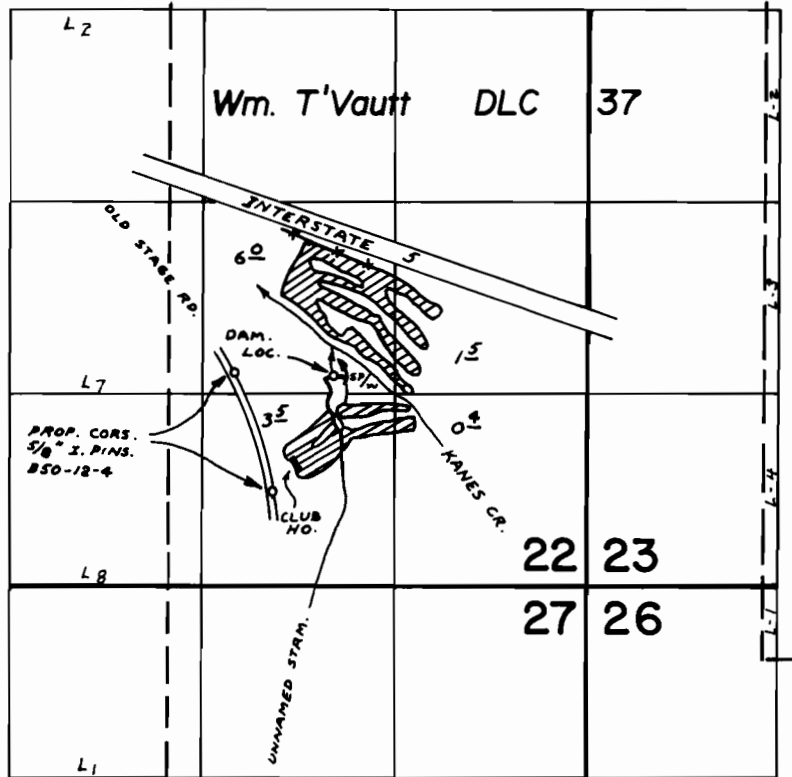

DAM LOC.: 1440' N & 1740' W FROM SE COR. SEC. 22

## FINAL PROOF SURVEY UNDER

R-54798                      R-6546  
54799                          41084

Application No. .... Permit No. ....  
IN NAME OF

HARVEY T. GRANGER & ASSO.

Surveyed NOV. 3 1978, by B. SUND